

DETAILS

Product Number	CN12488_MIRELLA-50-W-PIN-DL
Family	Mirella
Type	RefPack
Color	metal
Diameter	49,9 mm
Height	23,9 mm
Style	round
Optic Material	PC
Holder Material	
Fastening	pin
Status	production ready
ROHS Compliant	Yes
Date Updated	24/06/2013

OPTICAL PROPERTIES

LED	Viewing	Light	Efficiency	cd/lm	Connector
	Angle	Beam			
SM4	49 deg	Wide	77 %	1.080	-
XM-L	46 deg	Wide	80 %	1.000	-
XP-G	50 deg	Wide	80 %	1.050	-
XT-E	46 deg	Wide	77 %	0.950	-
XP-G2	45 deg	Wide	83 %	1.300	-
XM-L2	49 deg	Wide	81 %	1.100	-
MHB-A	51 deg	Wide	82 %	1.170	-
XHP50	51 deg	Wide	84 %	1.100	-
LUXEON A	48 deg	Wide	80 %	1.030	-
LUXEON M/MX	54 deg	Wide	80 %	0.980	-
LUXEON MZ	40 deg	Wide	82 %	1.500	-
NS9x383	46 deg	Wide	83 %	1.150	-
Oslon Square EC	50 deg	Wide	79 %	1.060	-
Duris S8	44 deg	Wide	83 %	1.300	-
Duris P10	sim: 50	Wide	sim: 87 %	sim: 1.200	-



Relative intensity of CN12488_MIRELLA-50-W-PIN-DL_(XM-L)

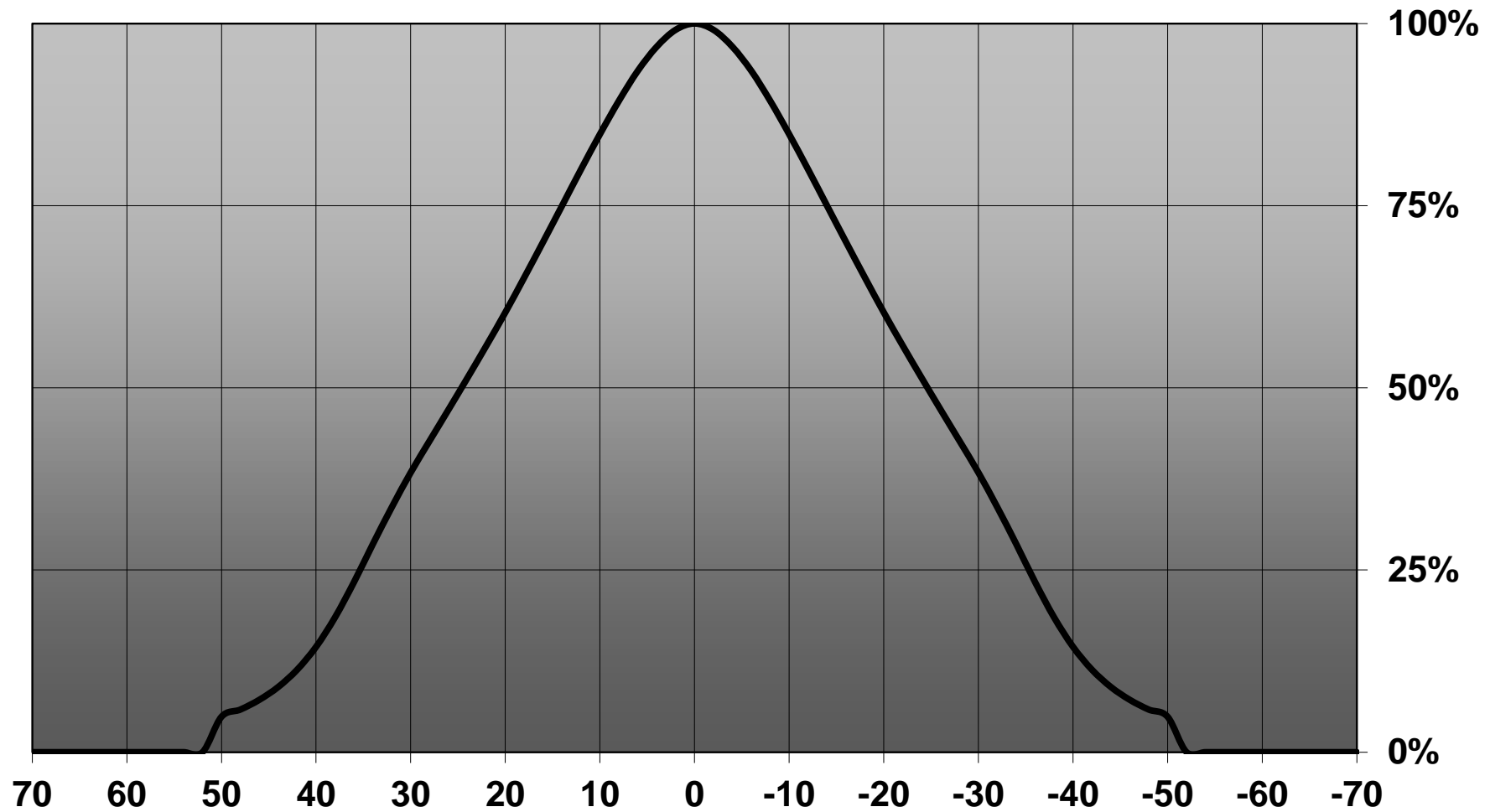

Relative intensity of CN12488_MIRELLA-50-W-PIN-DL_(XP-G)

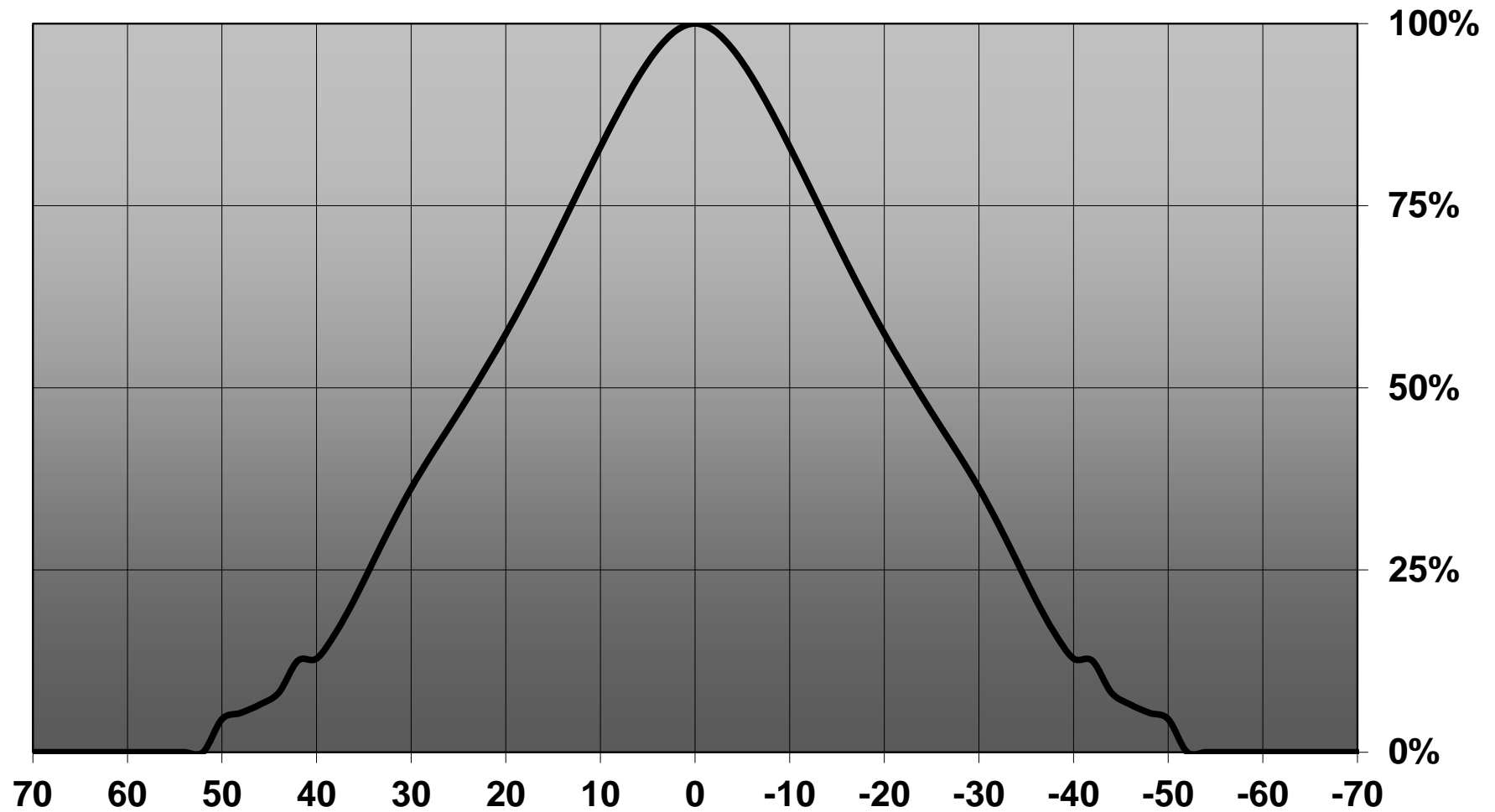

Relative intensity of CN12488_MIRELLA-50-W-PIN-DL_(XT-E)

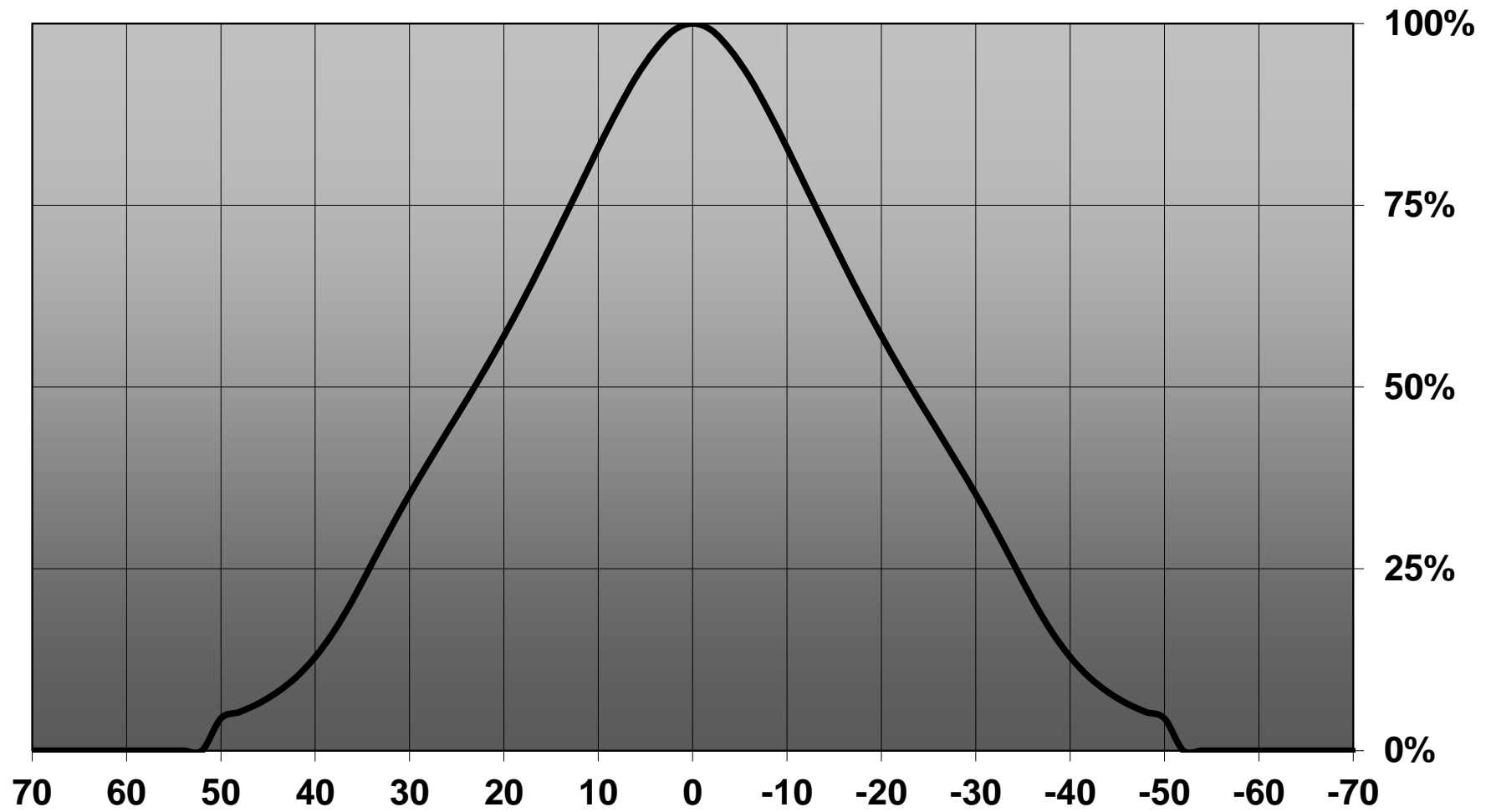

Relative intensity of CN12488_MIRELLA-50-W-PIN-DL-(XPG2)

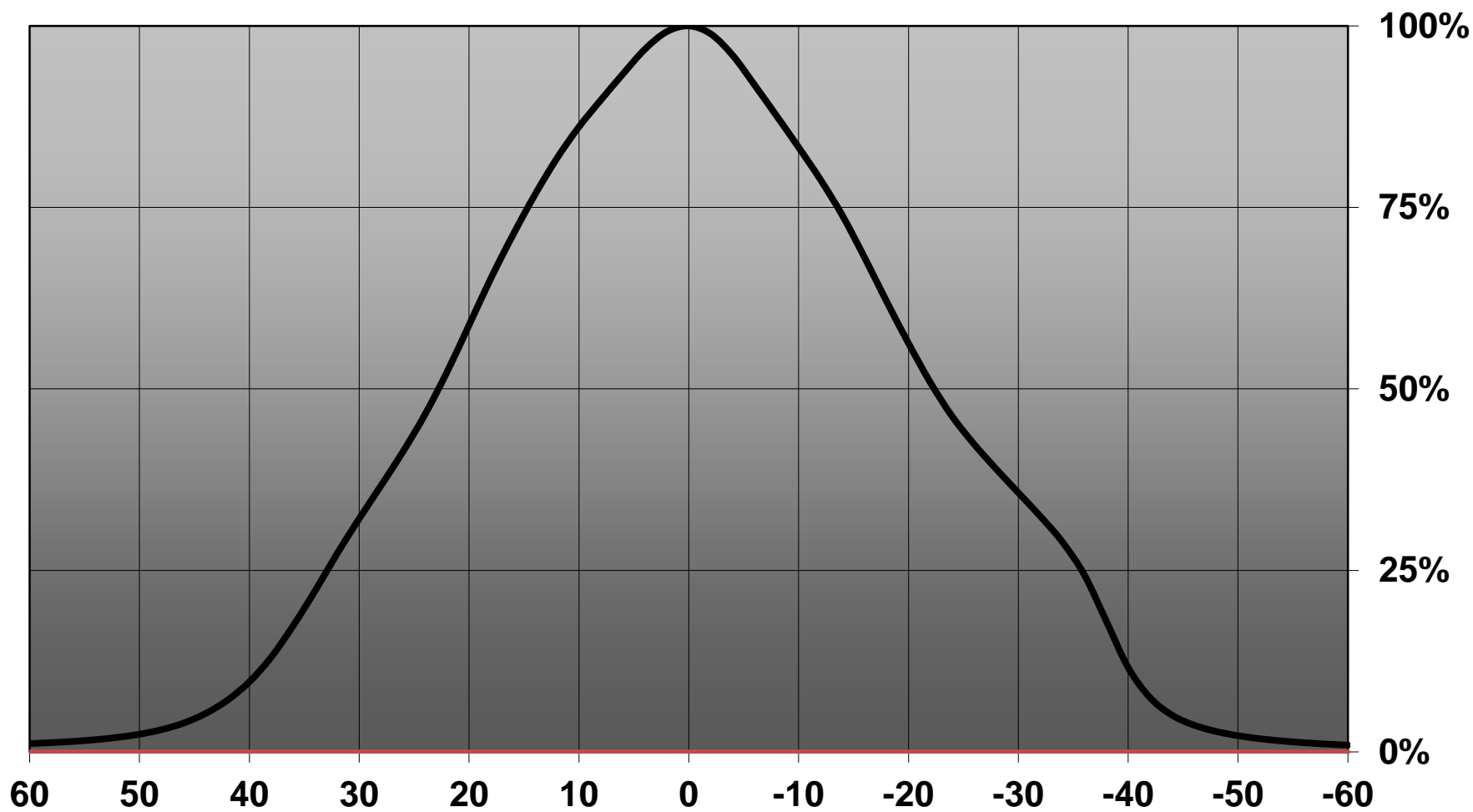

Relative intensity of CN12488_MIRELLA-50-W-PIN-DL_(MH-B)

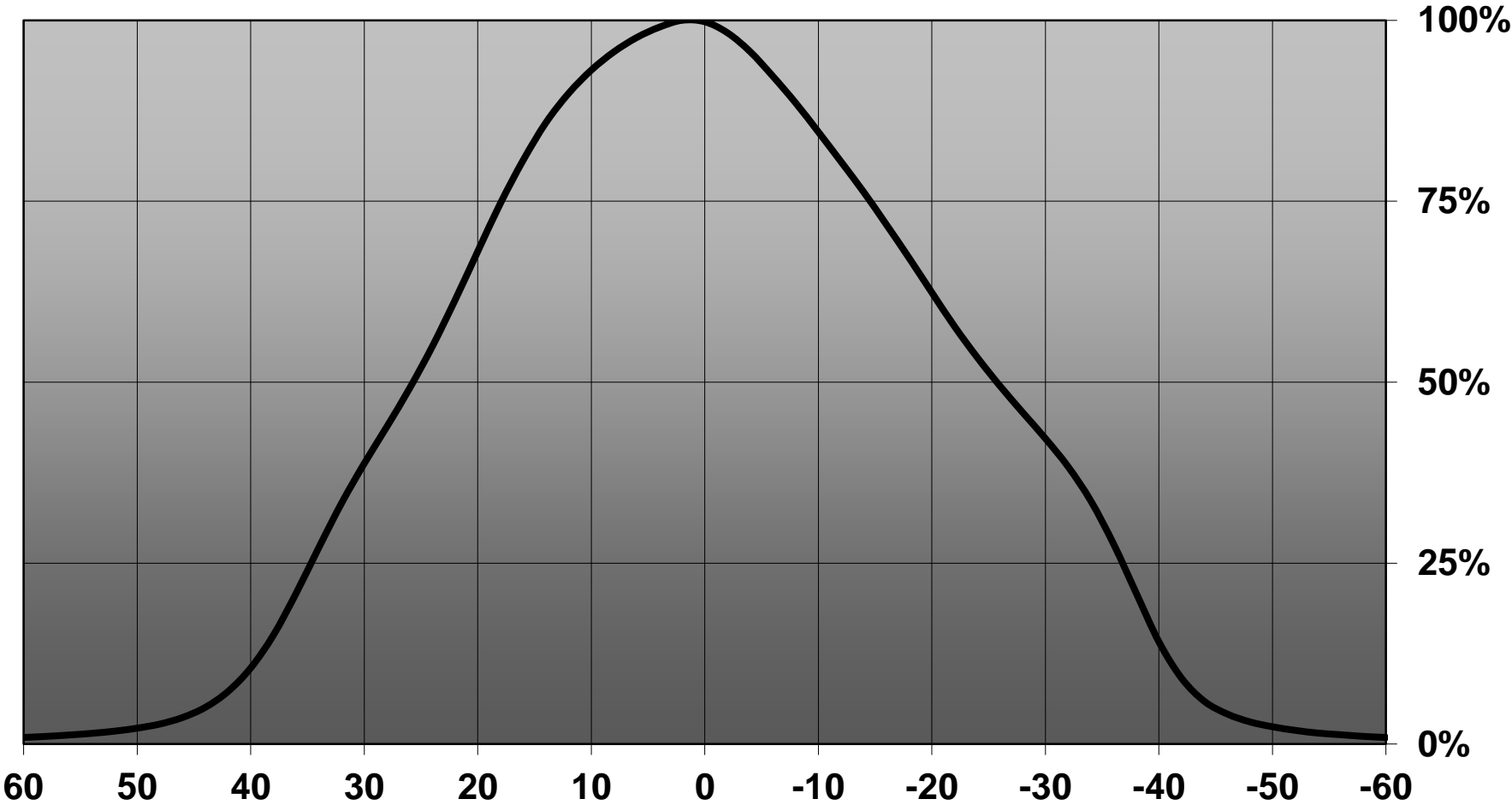

Relative intensity of CN12488_MIRELLA-50-W-PIN-DL_(LUXEON A)

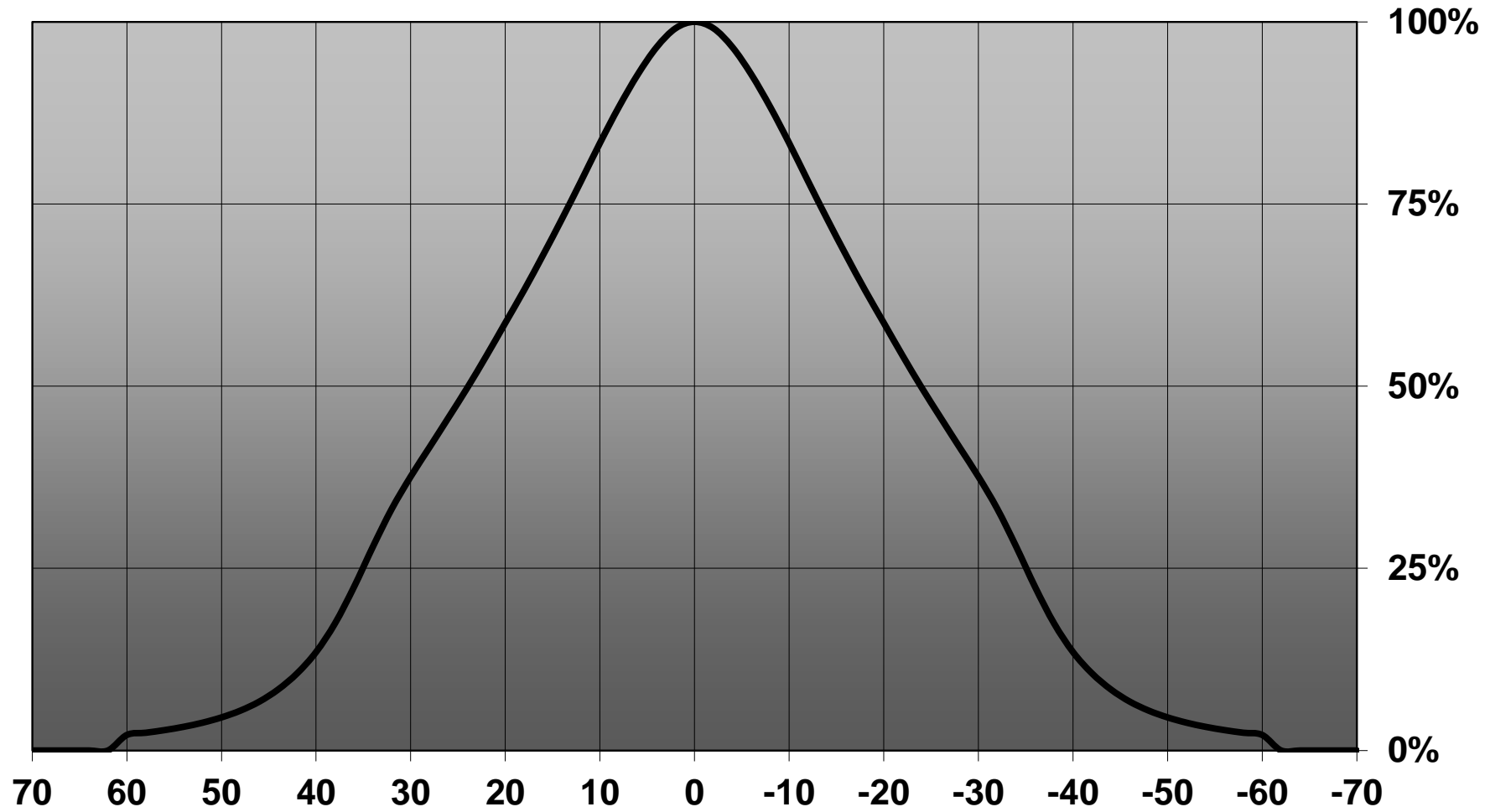

Relative intensity of CN12488_MIRELLA-50-W-PIN-DL_(LUXEON A)

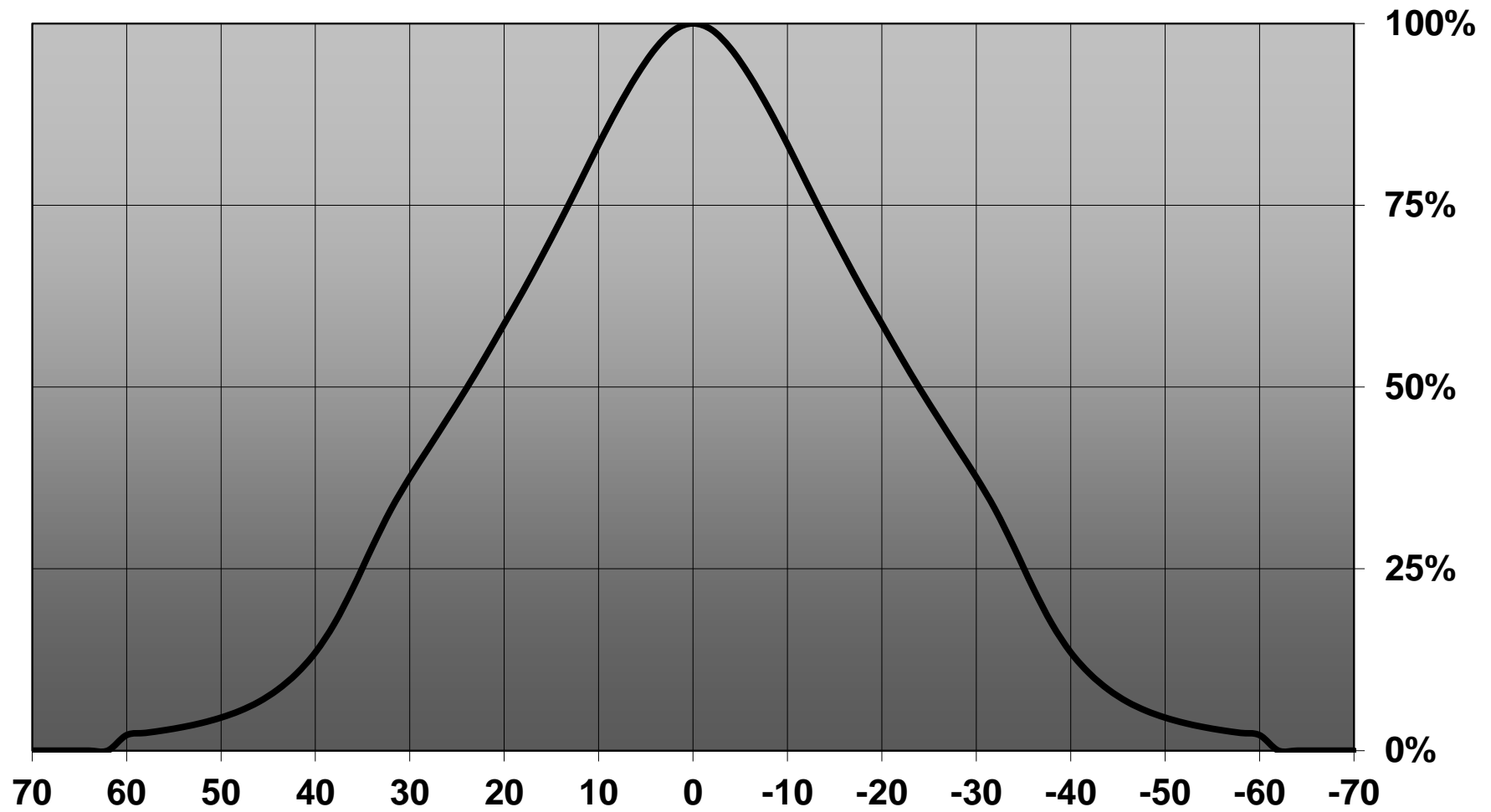

Relative intensity of CN12488_MIRELLA-50-W-PIN-DL_(OSLON-SQ-EC)

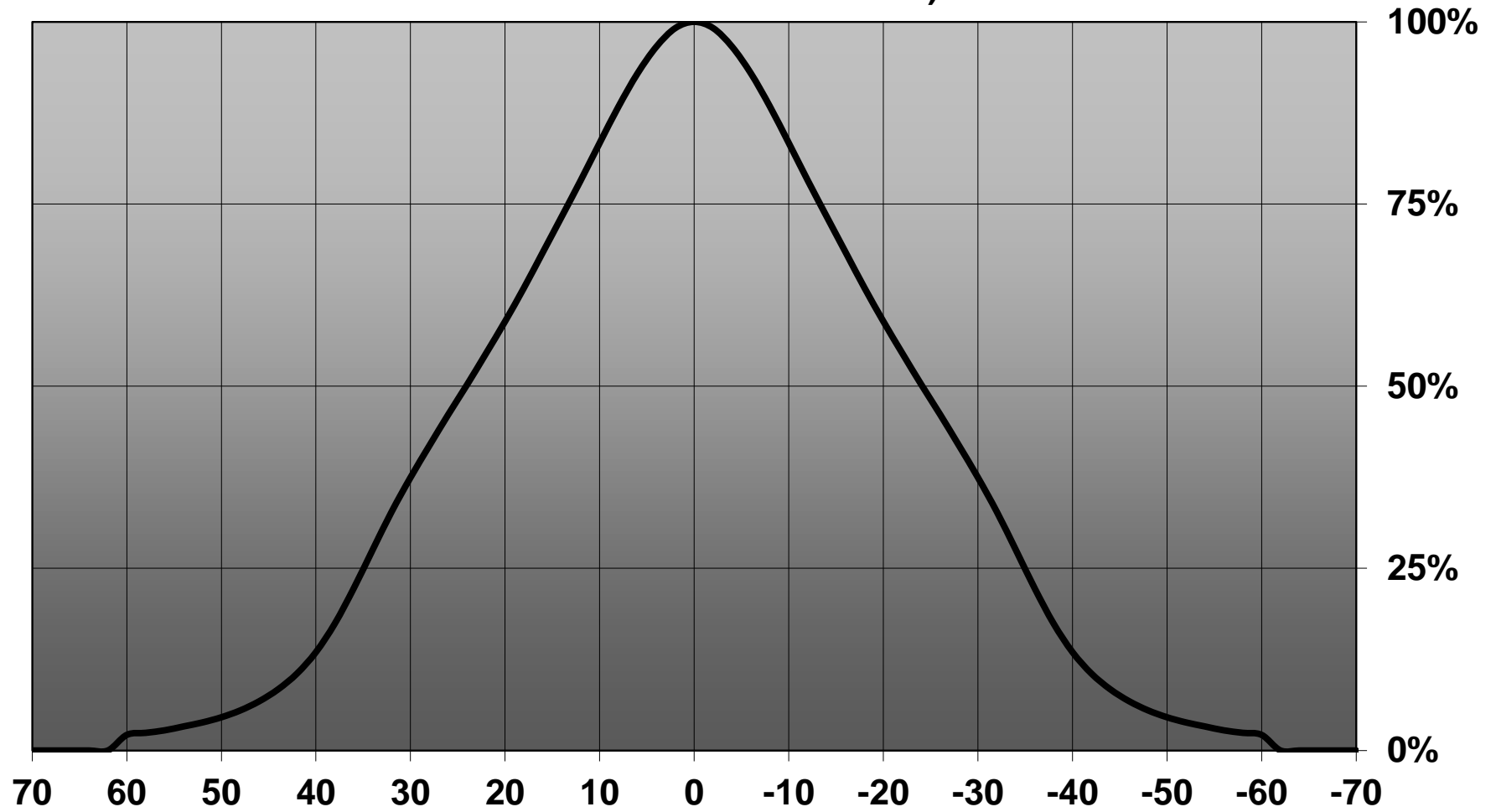

D

C

B

A

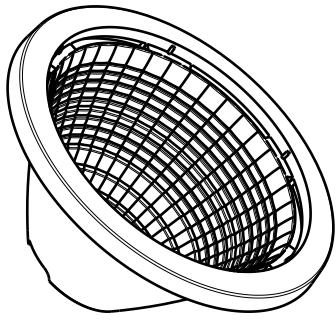

Isometric view

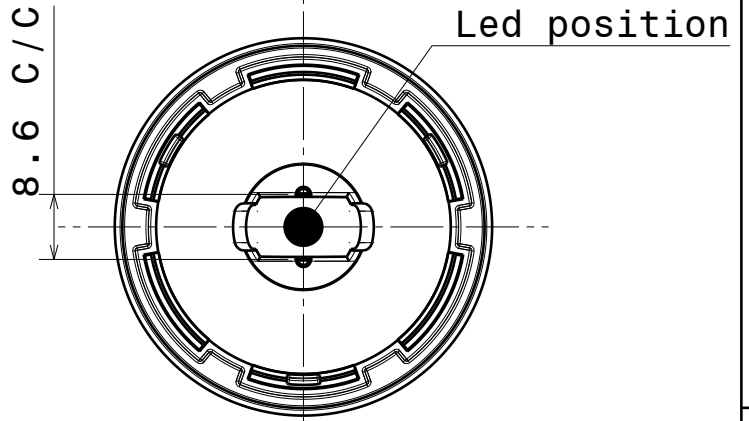

Bottom view

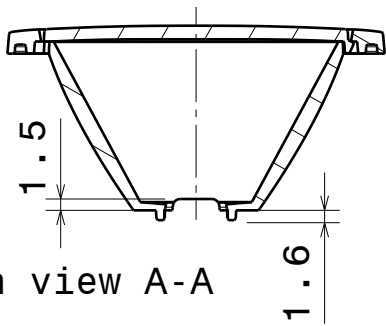

Section view A-A

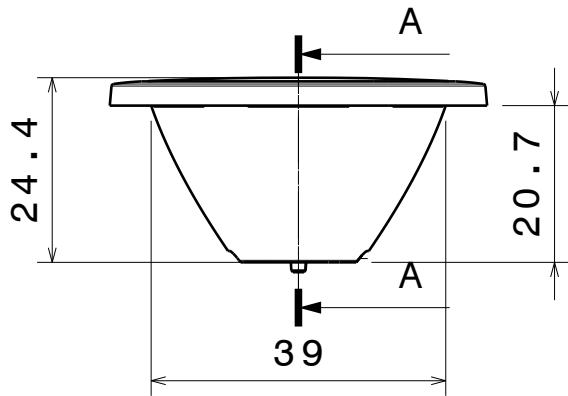

Front view

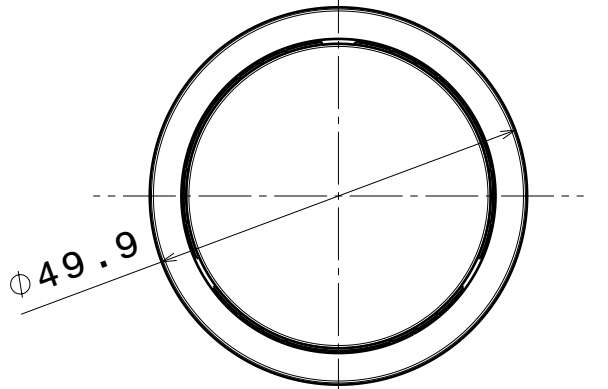

Top view

Tolerances if not otherwise shown
 According to DIN ISO 2768-1
 Linear measures:
 Up to 30mm class M, otherwise class C.
 According to DIN ISO 2768-2
 Form and position: class L



Ledil Oy
 Salorankatu 10
 FIN 24240 SALO
 Finland

THIRD ANGLE PROJECTION:

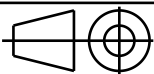

DRAWING TITLE

Datasheet_Mirella_pin

This drawing is the property
 of LEDiL Oy. It may not be
 reproduced, copied or
 communicated without a written
 agreement with LEDiL Oy."

SIZE	PART NUMBER
A4	-

SCALE	1:1	WEIGHT	-
-------	-----	--------	---

SHEET	1/1
-------	-----

D

A

Luminaire: LEDiL CN12488_MIRELLA-50-W-PIN-DL_(SM4) Eff. 77%
Lamps: 1 x Bridgelux SM4 (259lm@250mA)

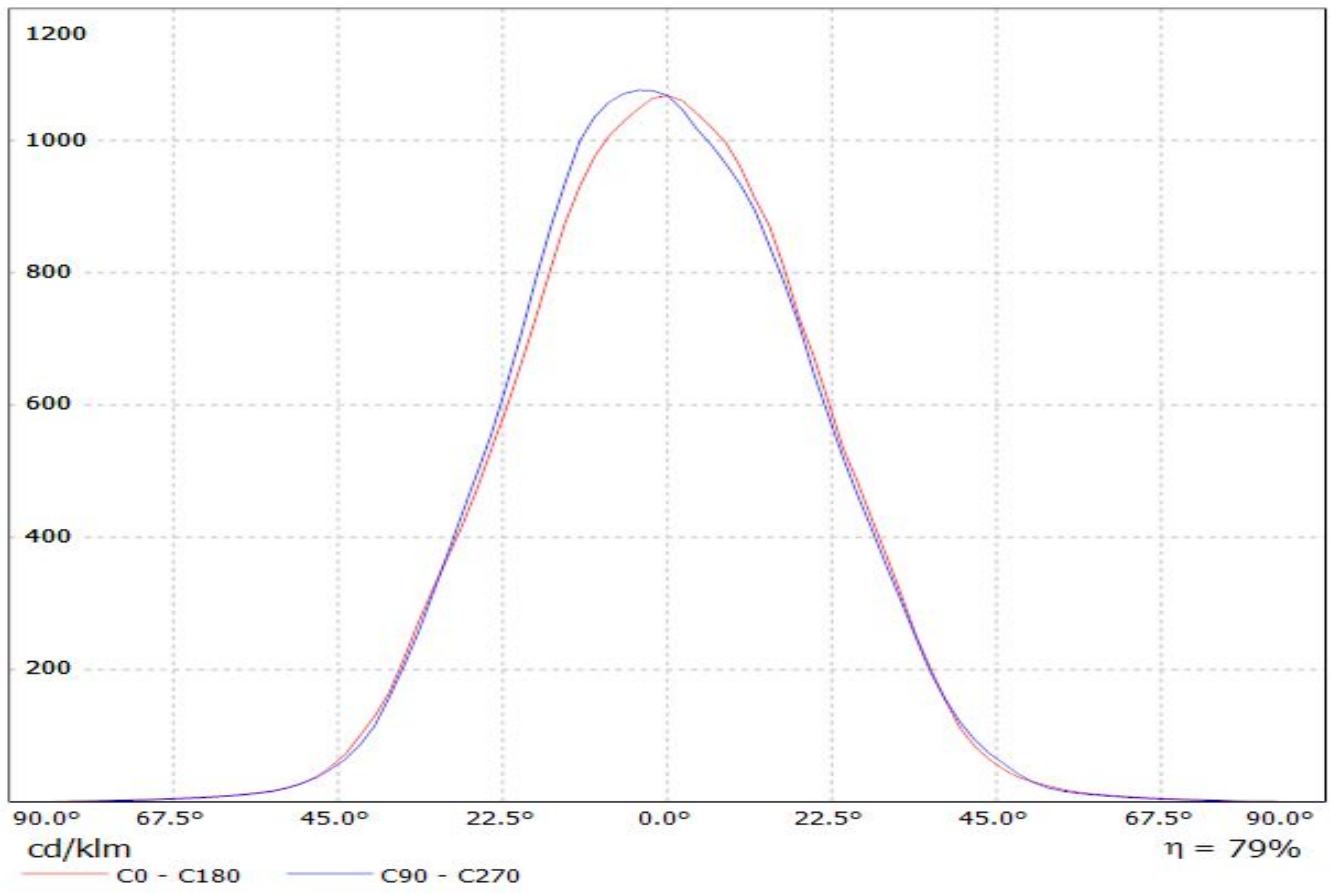

Luminaire: Ledil Oy CN12488_MIRELLA-50-W-PIN-DL (Cree XM-L 111lm @ 250mA) Efficiency=80%
Lamps: 1 x Cree XM-L 111lm @ 250mA

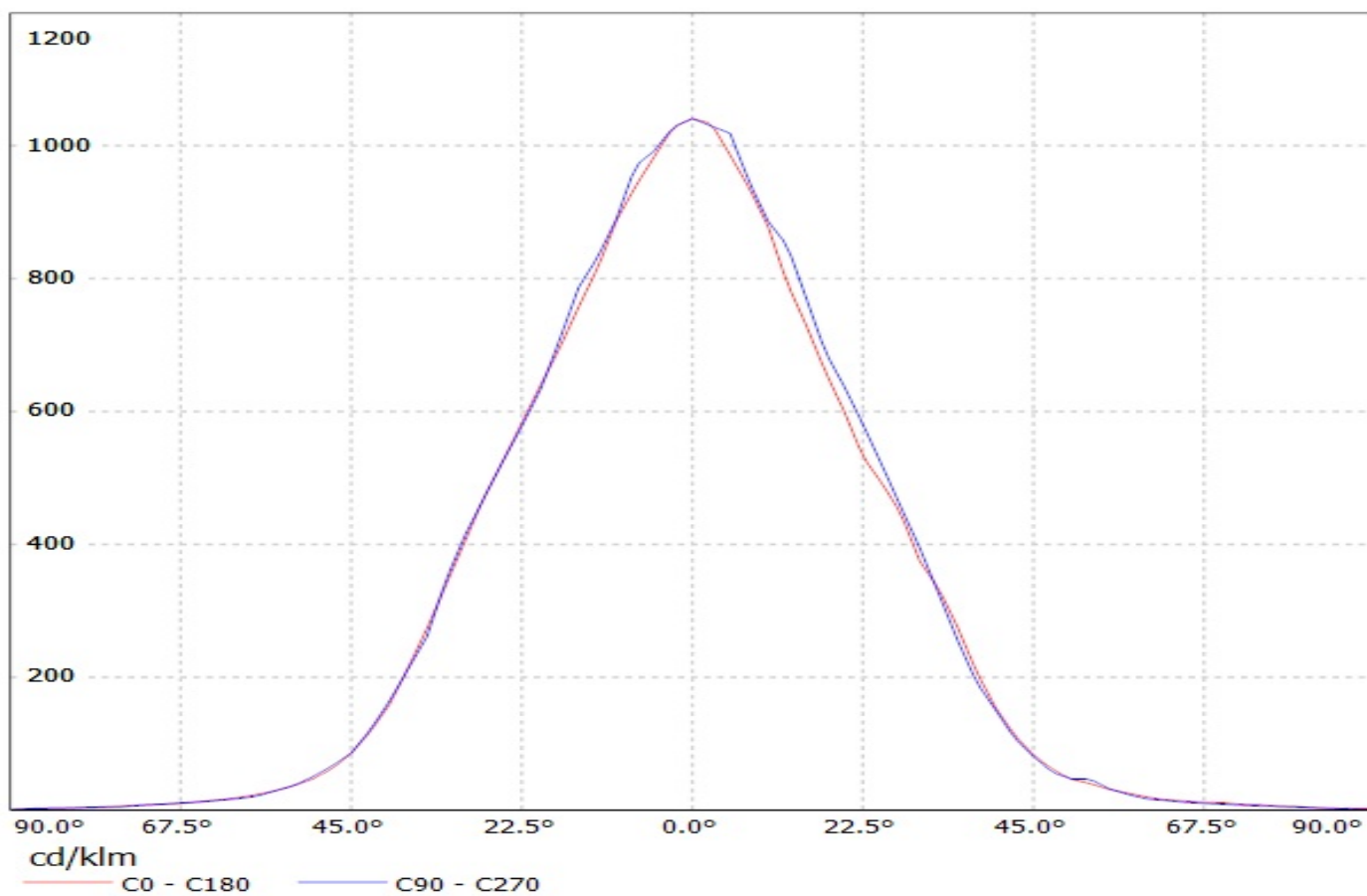

Luminaire: Ledil Oy CN12488_MIRELLA-50-W-PIN-DL (Cree XP-G 92lm @ 250mA) Efficiency=80%
Lamps: 1 x Cree XP-G 92lm @ 250mA

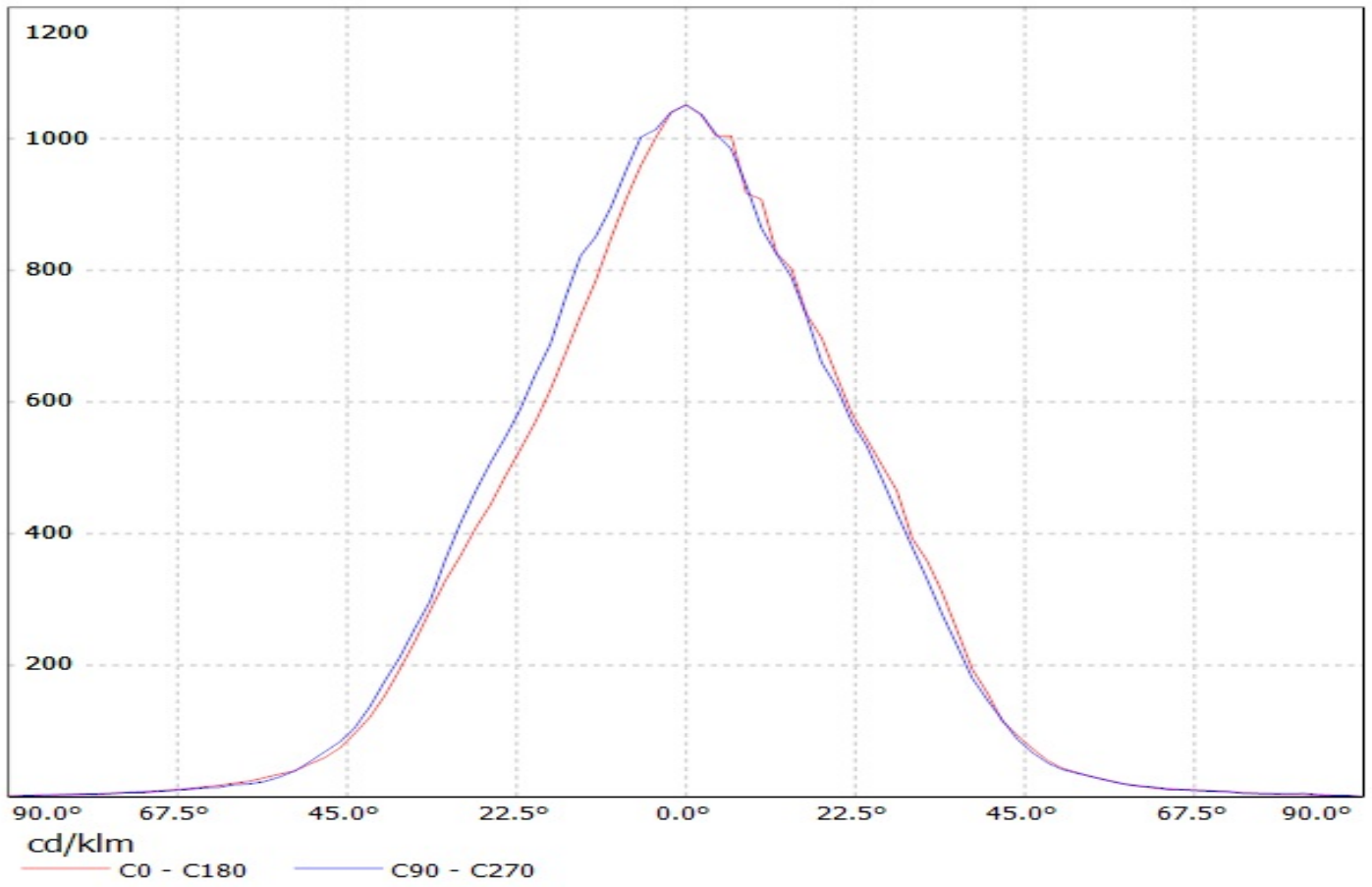

Luminaire: Ledil Oy CN12488_MIRELLA-50-W-PIN-DL (Cree XT-E 113lm @ 250mA) Efficiency=77%
Lamps: 1 x Cree XT-E 113lm @ 250mA

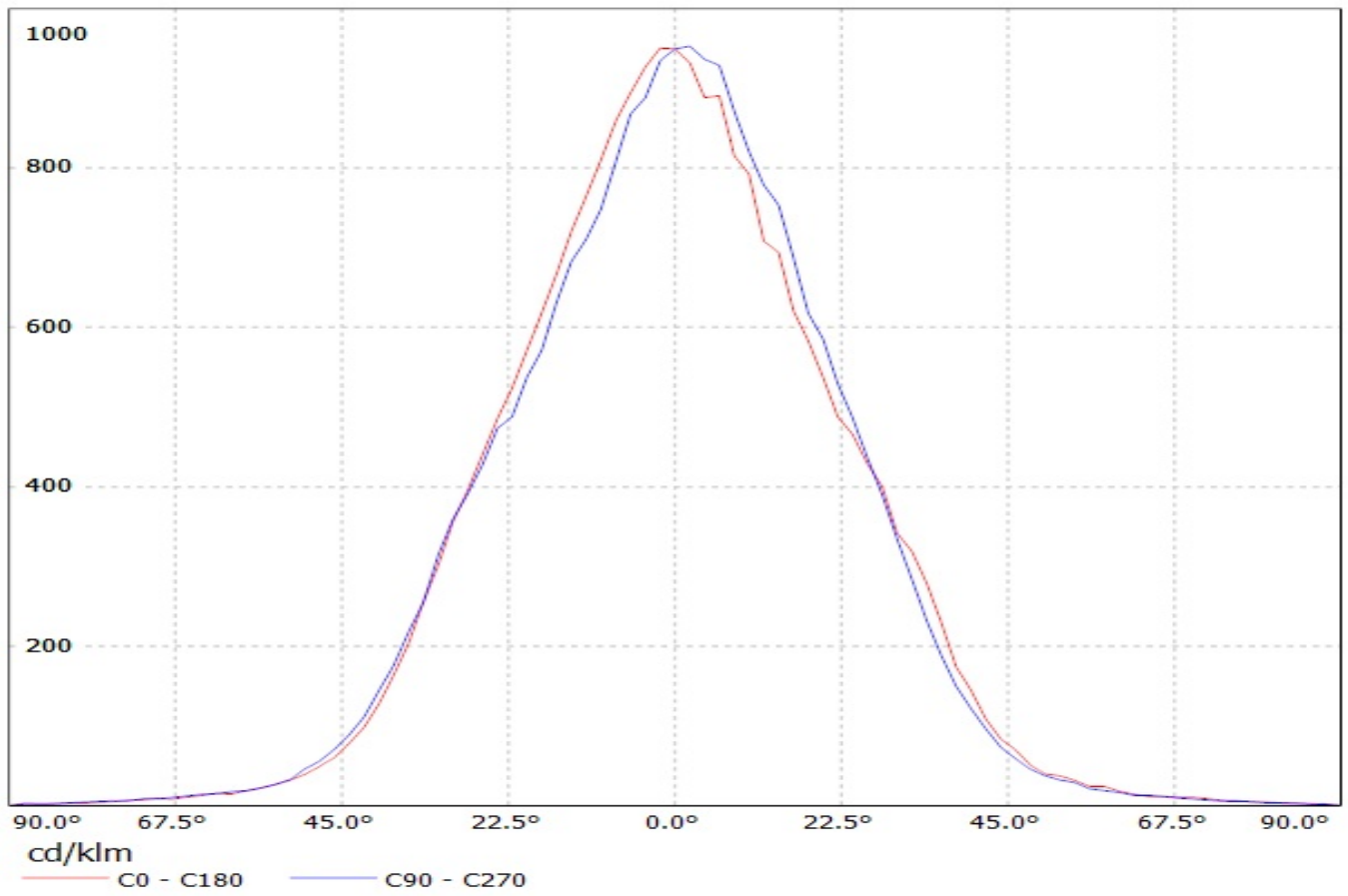

Luminaire: LEDil Oy CN12488_MIRELLA-50-W-PIN-DL_(XM-L2) Efficiency=81%
Lamps: 1 x Cree XM-L2 (100lm @ 250mA) P=0.7W I=250mA

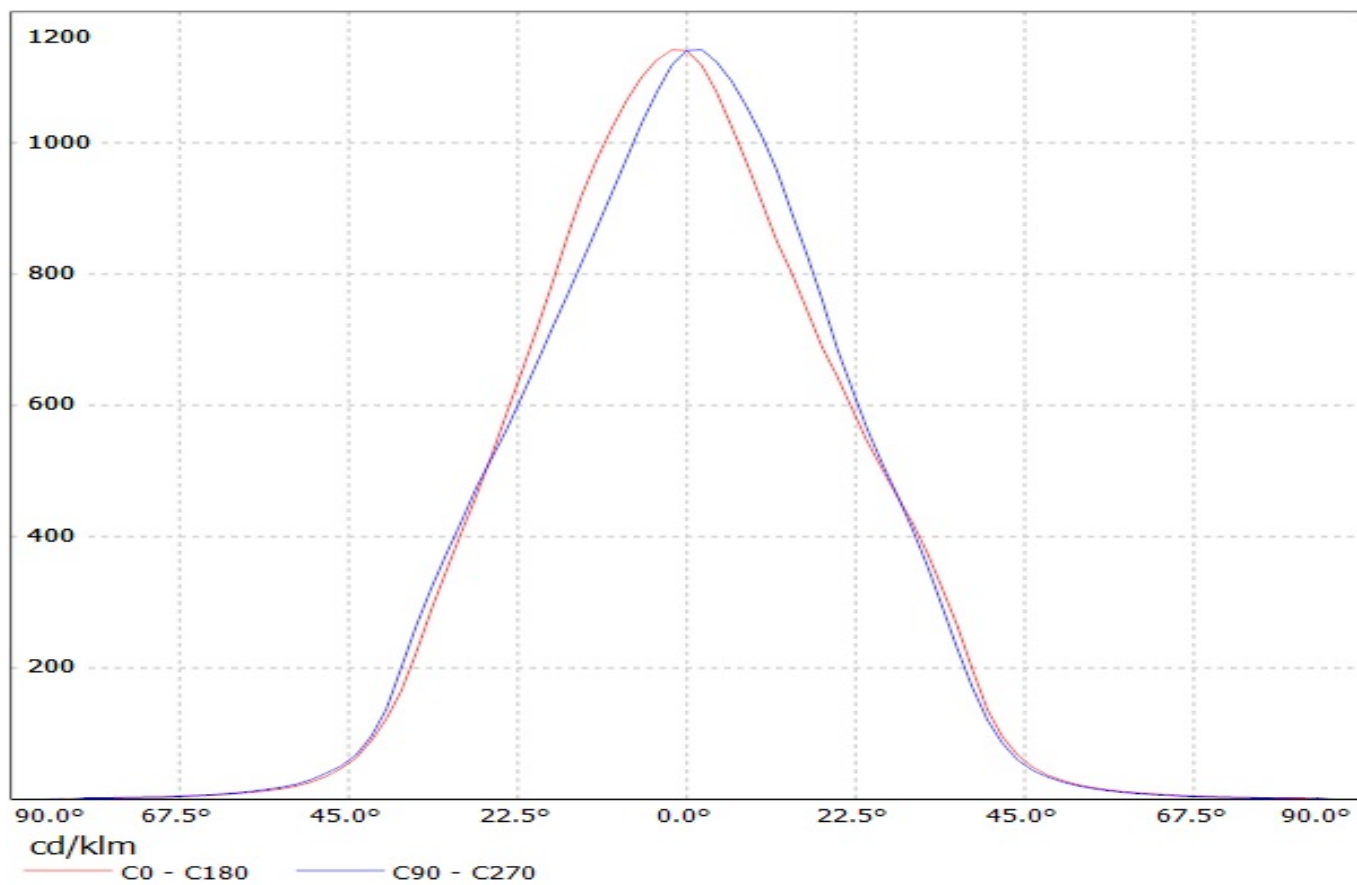

Luminaire: LEDiL Oy CN12488_MIRELLA-50-W-PIN-DL_(CREE_XHP50_WARM_WHITE)
Lamps: 1 x CREE_XHP50_WARM_WHITE_195.49lm@250mA_P=1.39994W_I=0.2499A

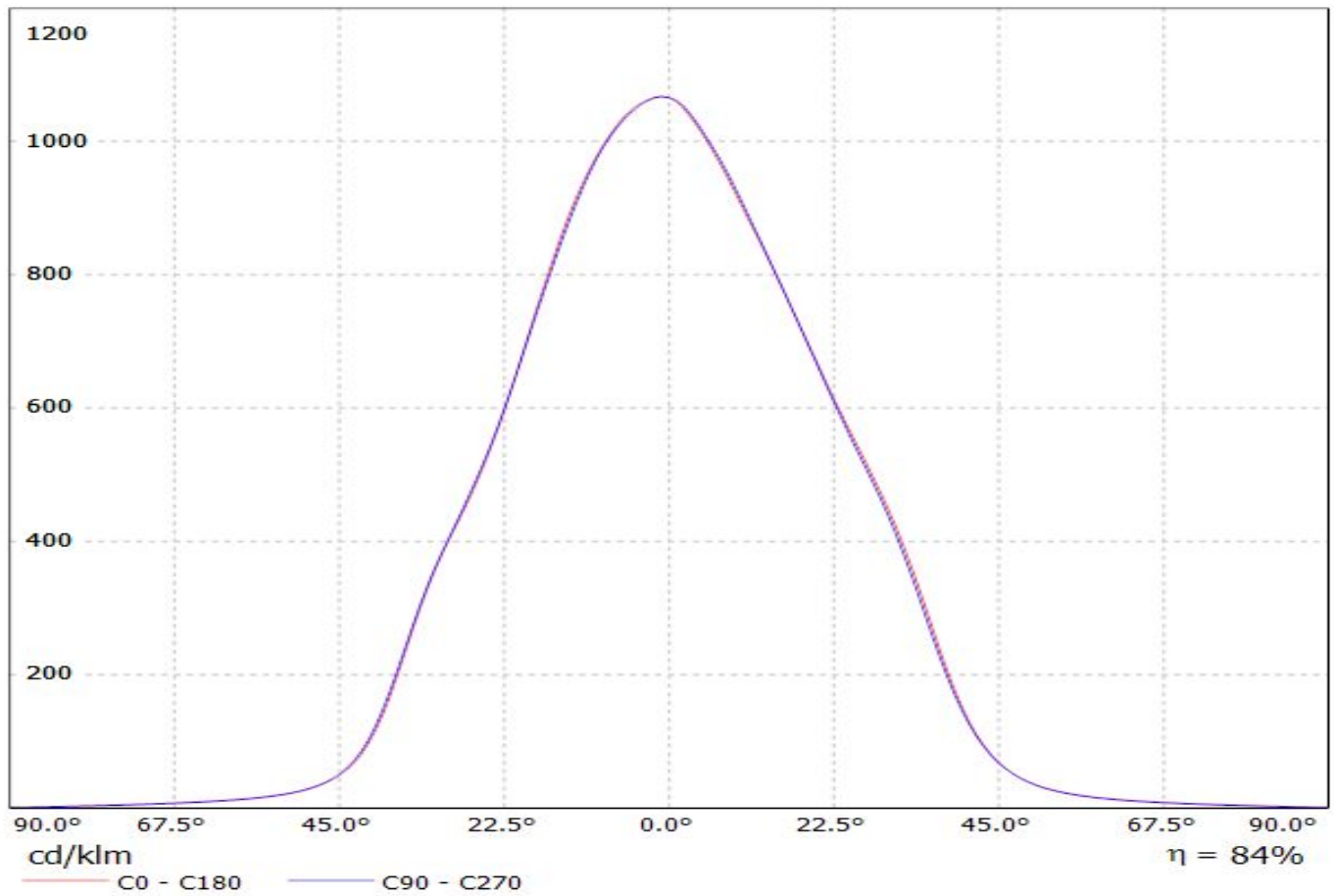

Luminaire: Ledil Oy CN12488_MIRELLA-50-W-PIN-DL (Luxeon A 70lm @ 250mA) Efficiency=80%
Lamps: 1 x Luxeon A 70lm @ 250mA

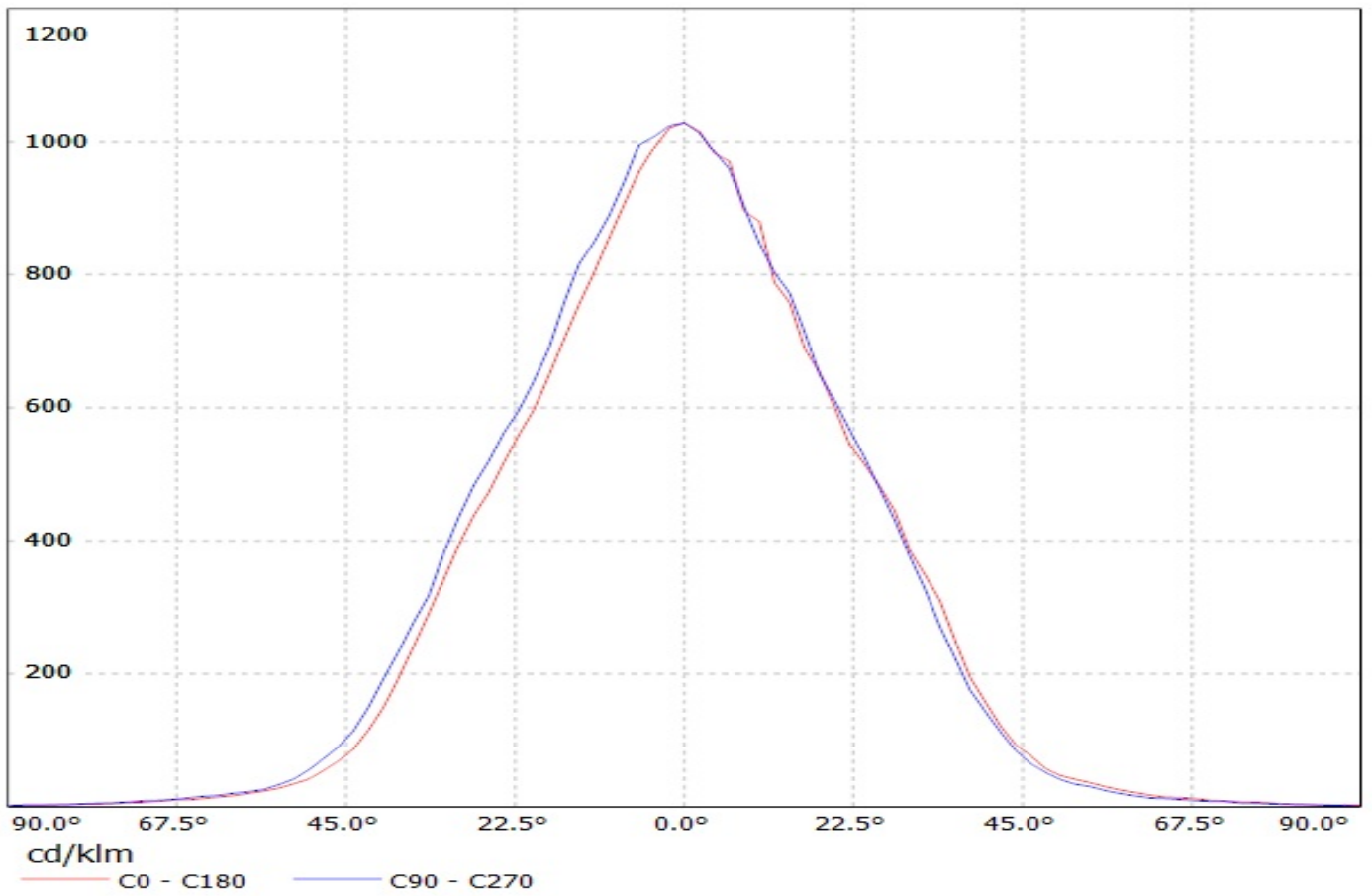

Luminaire: Ledil Oy CN12488_MIRELLA-50-W-PIN-DL_(Luxeon_M) Efficiency=80%
Lamps: 1 x Philips Lumileds Luxeon M (347lm @ 250mA) CCT=4100K P=2.7W I=250mA

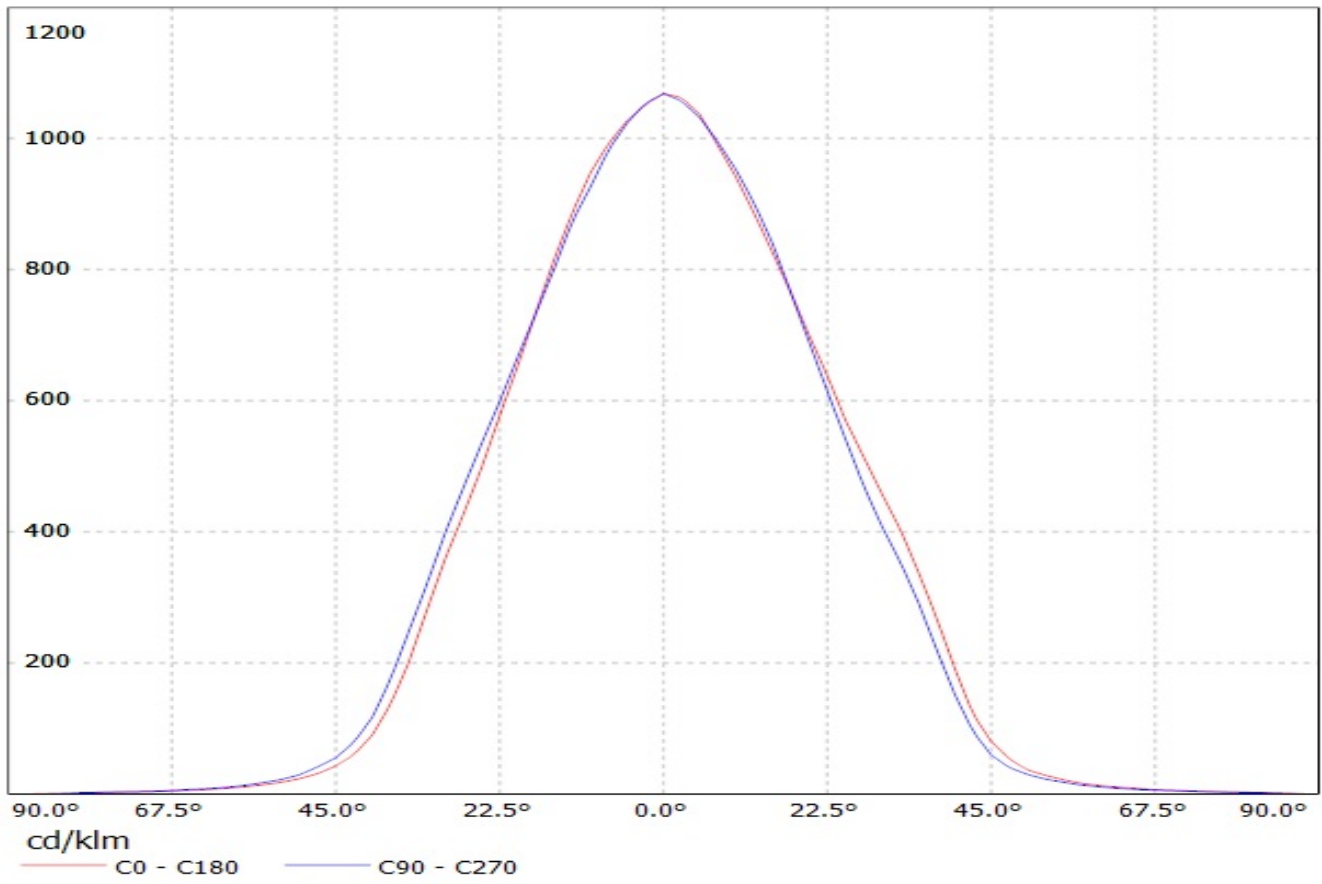

Luminaire: LEDil Oy CN12488_MIRELLA-50-W-PIN-DL_(Luxeon_MZ) Efficiency=82%
Lamps: 1 x Philips Lumileds Luxeon MZ (389lm @ 250mA) CCT=3800K P=2.8W I=250mA

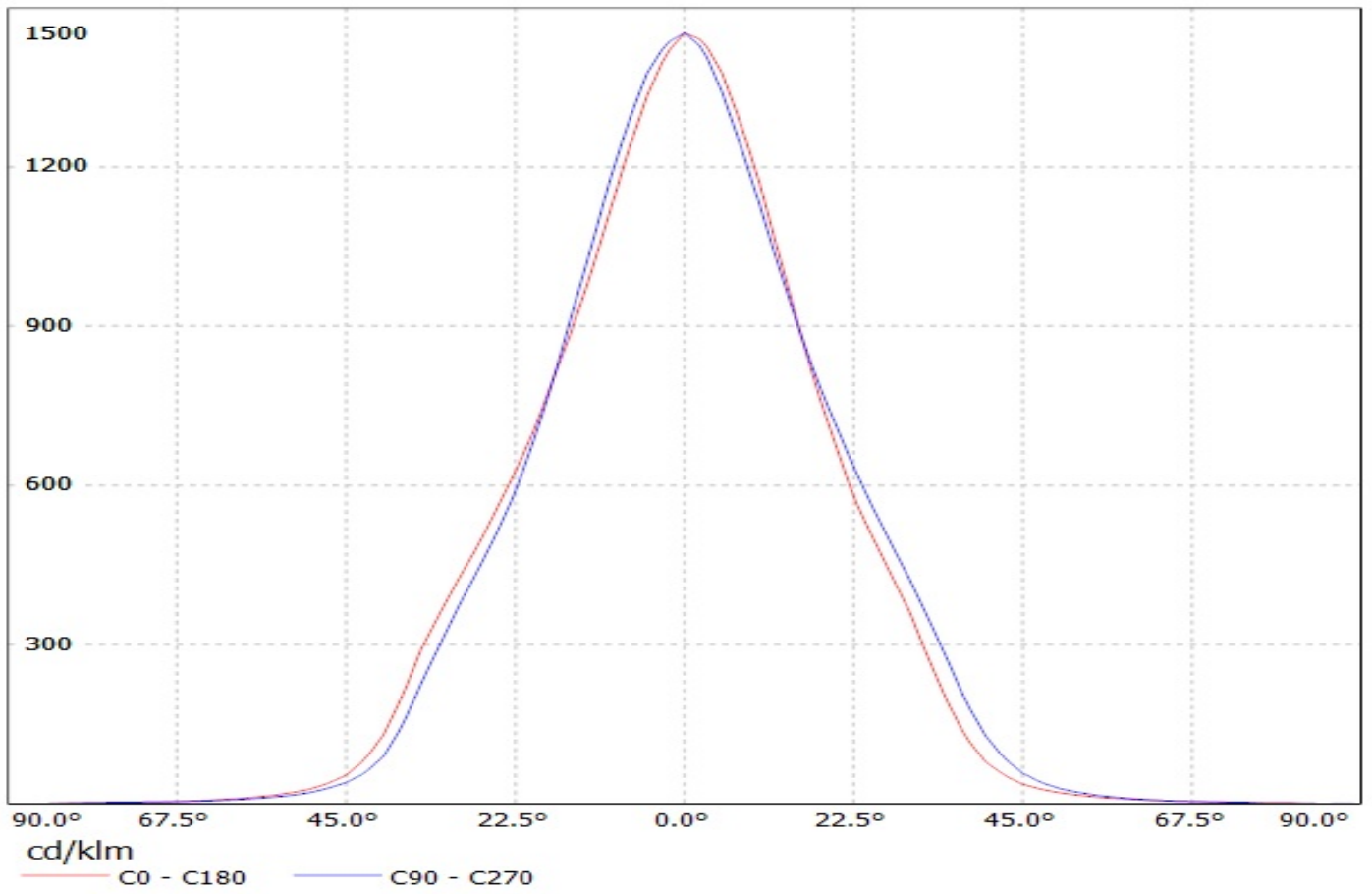

Luminaire: LEDiL Oy CN12488_MIRELLA-50-W-PIN-DL_(NS9x383) Eff. 82,5%
Lamps: 1 x Nichia NS9x383 (105lm@250mA)

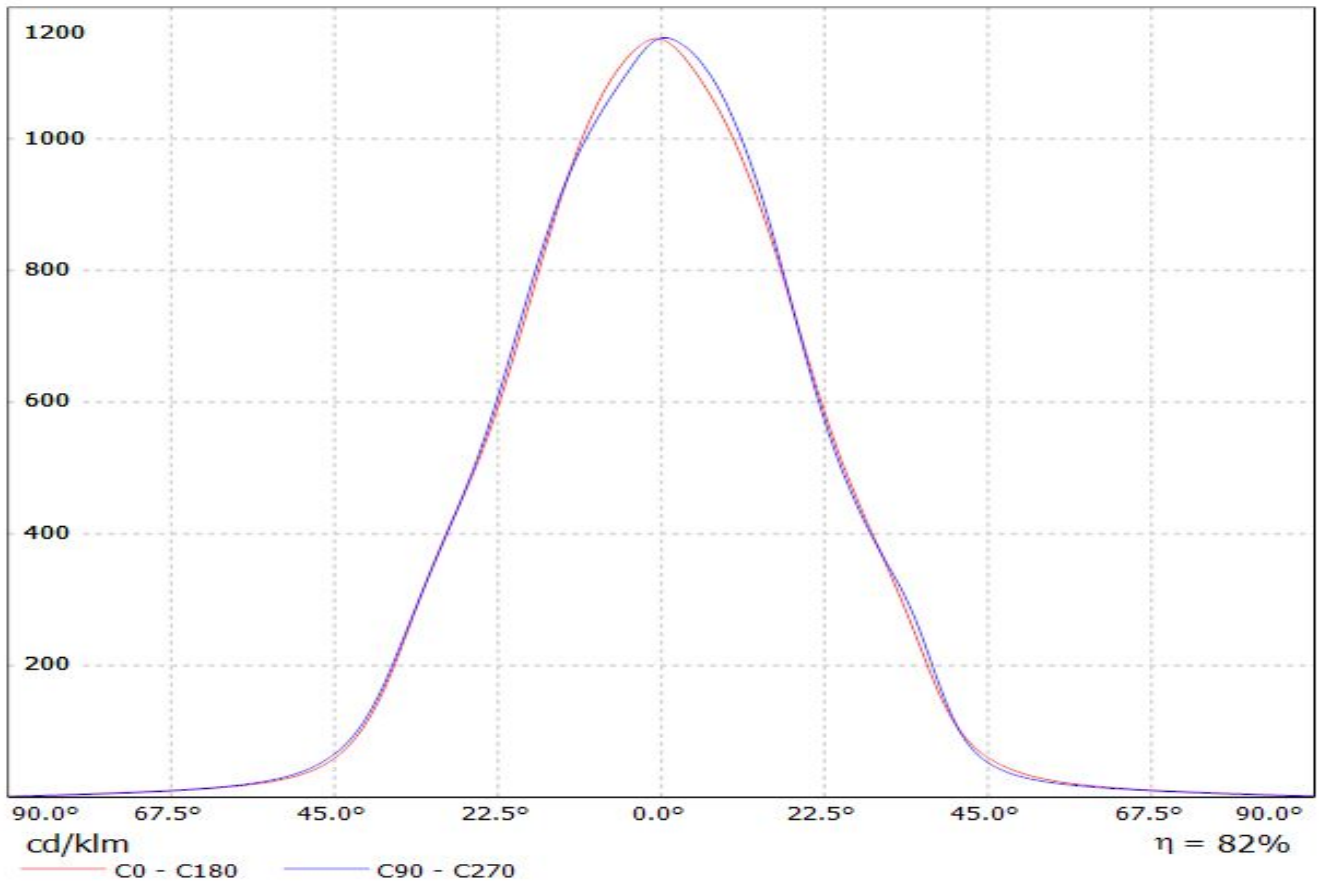

Luminaire: Ledil Oy CN12488_MIRELLA-50-W-PIN-DL (Osram Square EC 78lm @ 250mA) Efficiency=79%
Lamps: 1 x Osram Square EC 78lm @ 250mA

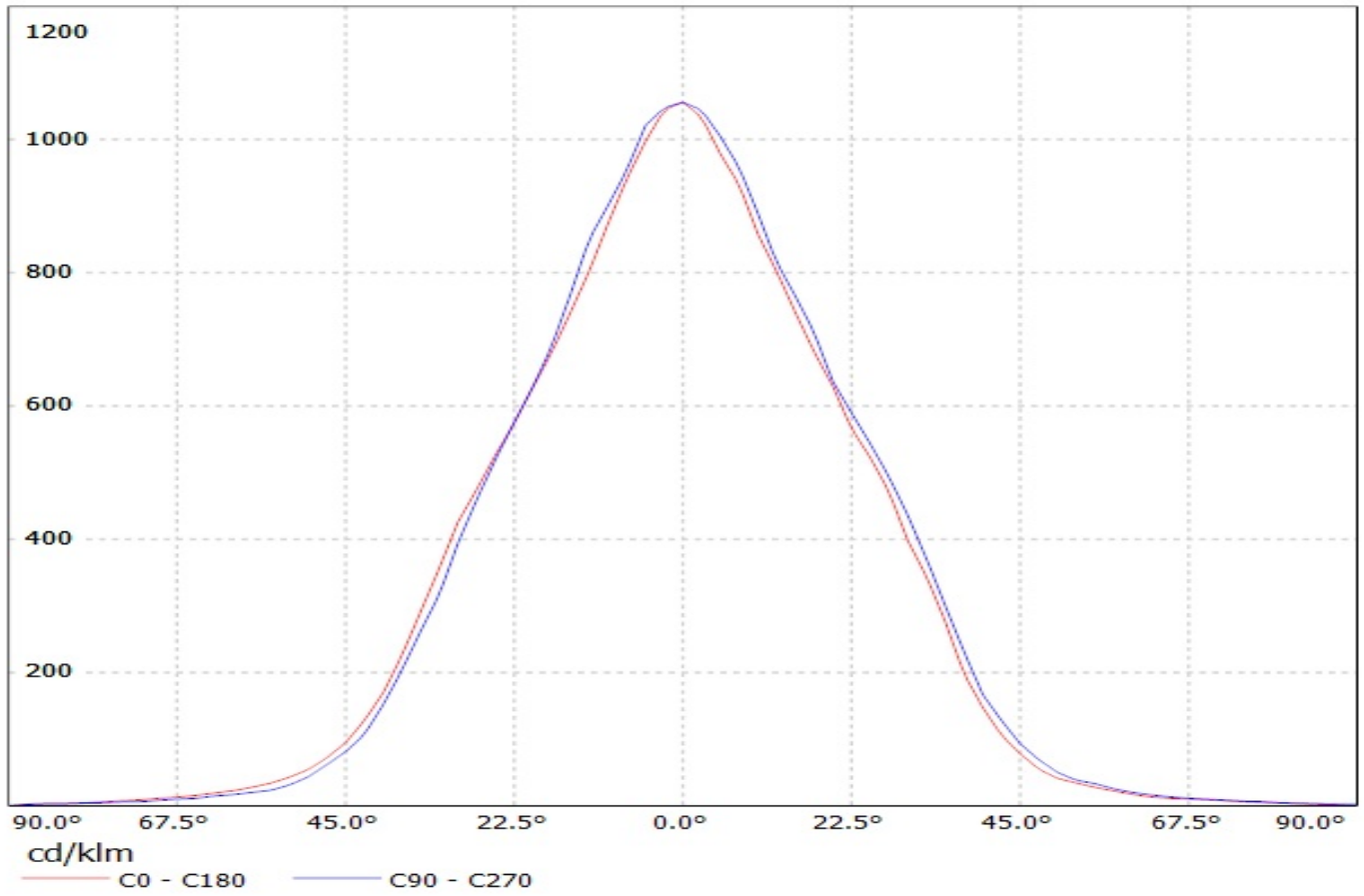

Luminaire: Ledil Oy CN12488_MIRELLA-50-W-PIN-DL (Osram Duris S8 190lm @ 100mA) Efficiency=83%
Lamps: 1 x Osram Duris S8 190lm @ 100mA (GWP9LMS1.EC) CCT=2857K P=1,8W I=100mA

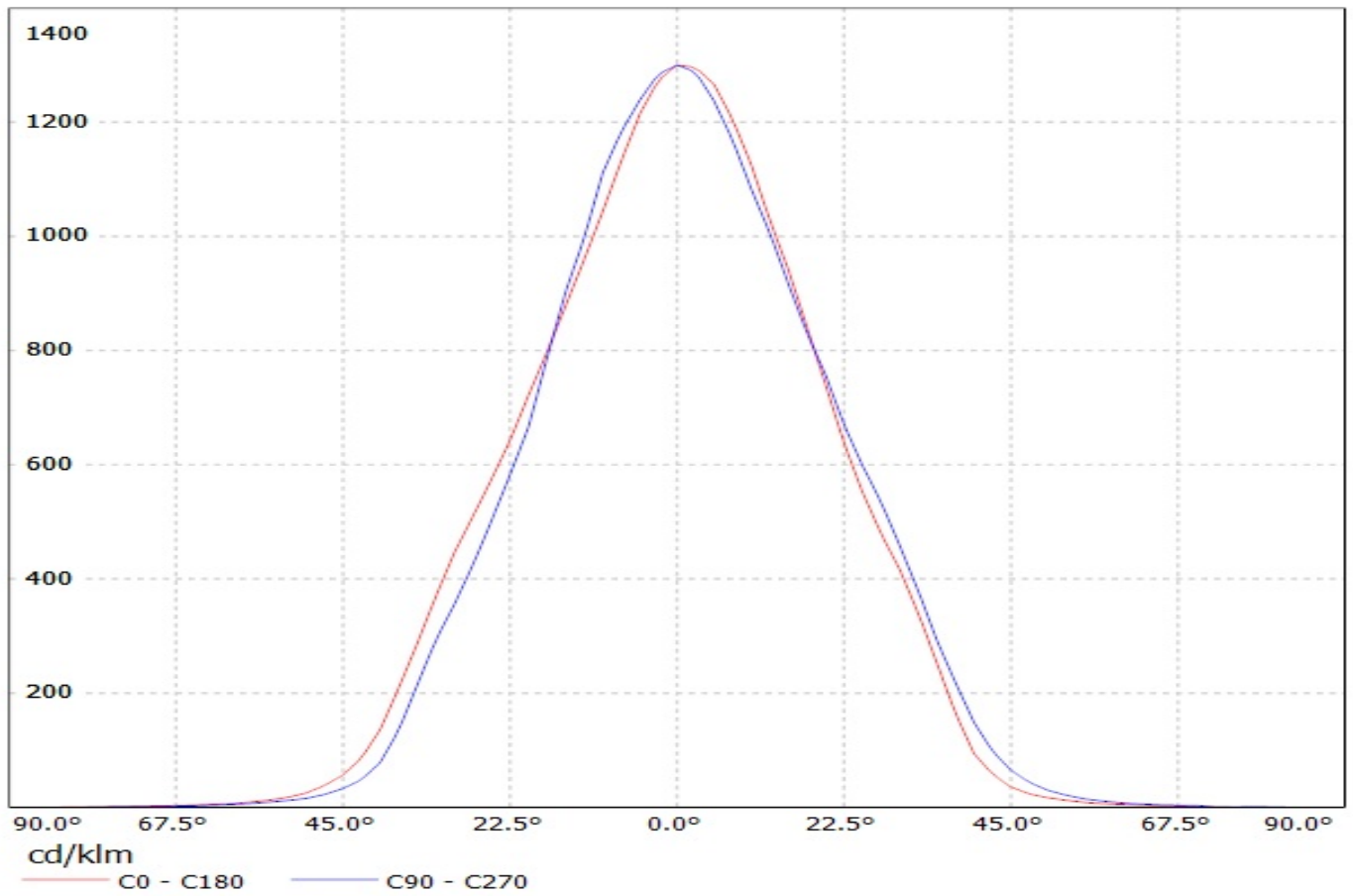

Luminaire: LEDiL CN12488_MIRELLA-50-W-PIN-DL_(SM4) Eff. 77%
Lamps: 1 x Bridgelux SM4 (259lm@250mA)

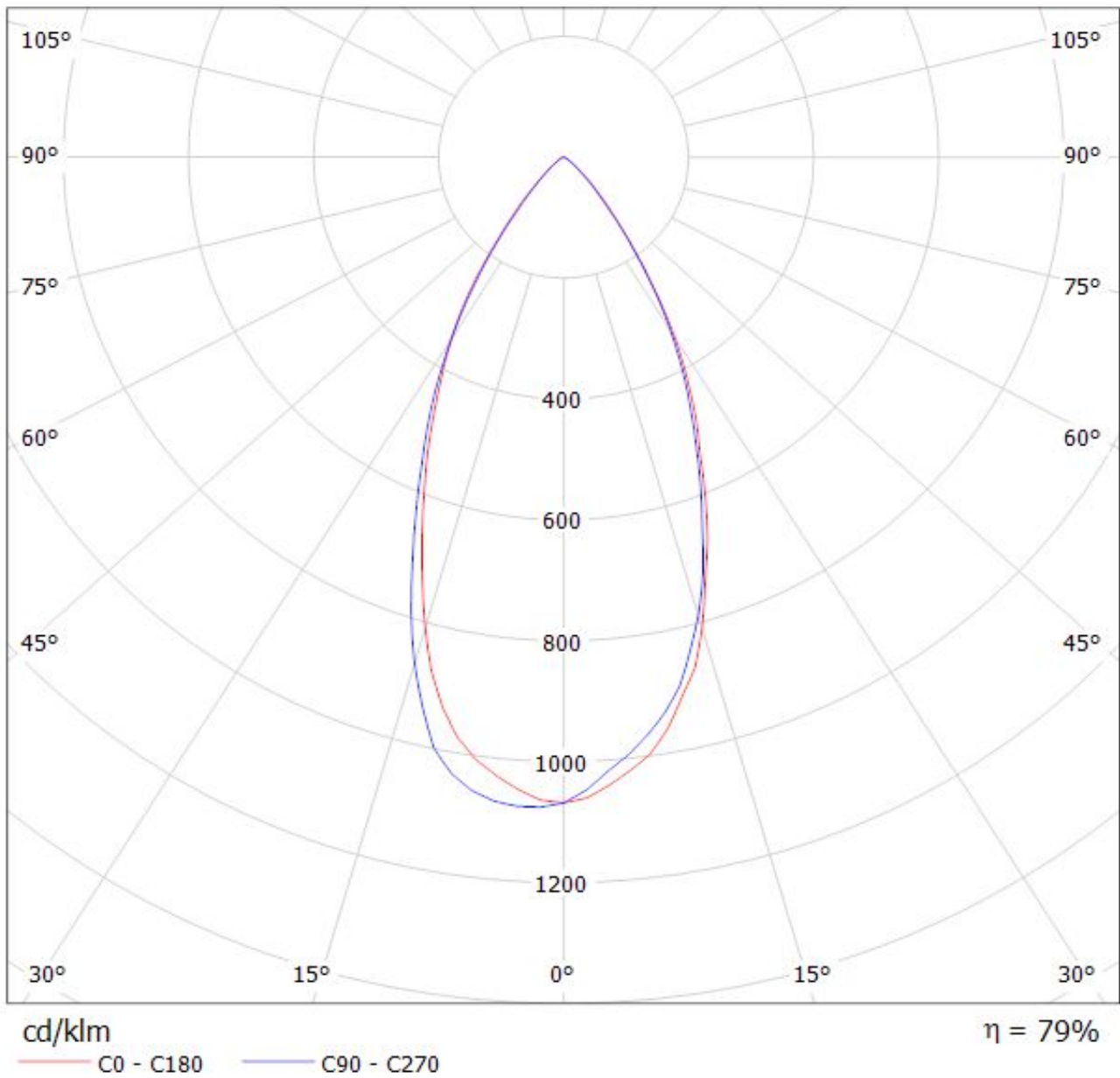

Luminaire: Ledil Oy CN12488_MIRELLA-50-W-PIN-DL (Cree XM-L 111lm @ 250mA) Efficiency=80%
Lamps: 1 x Cree XM-L 111lm @ 250mA

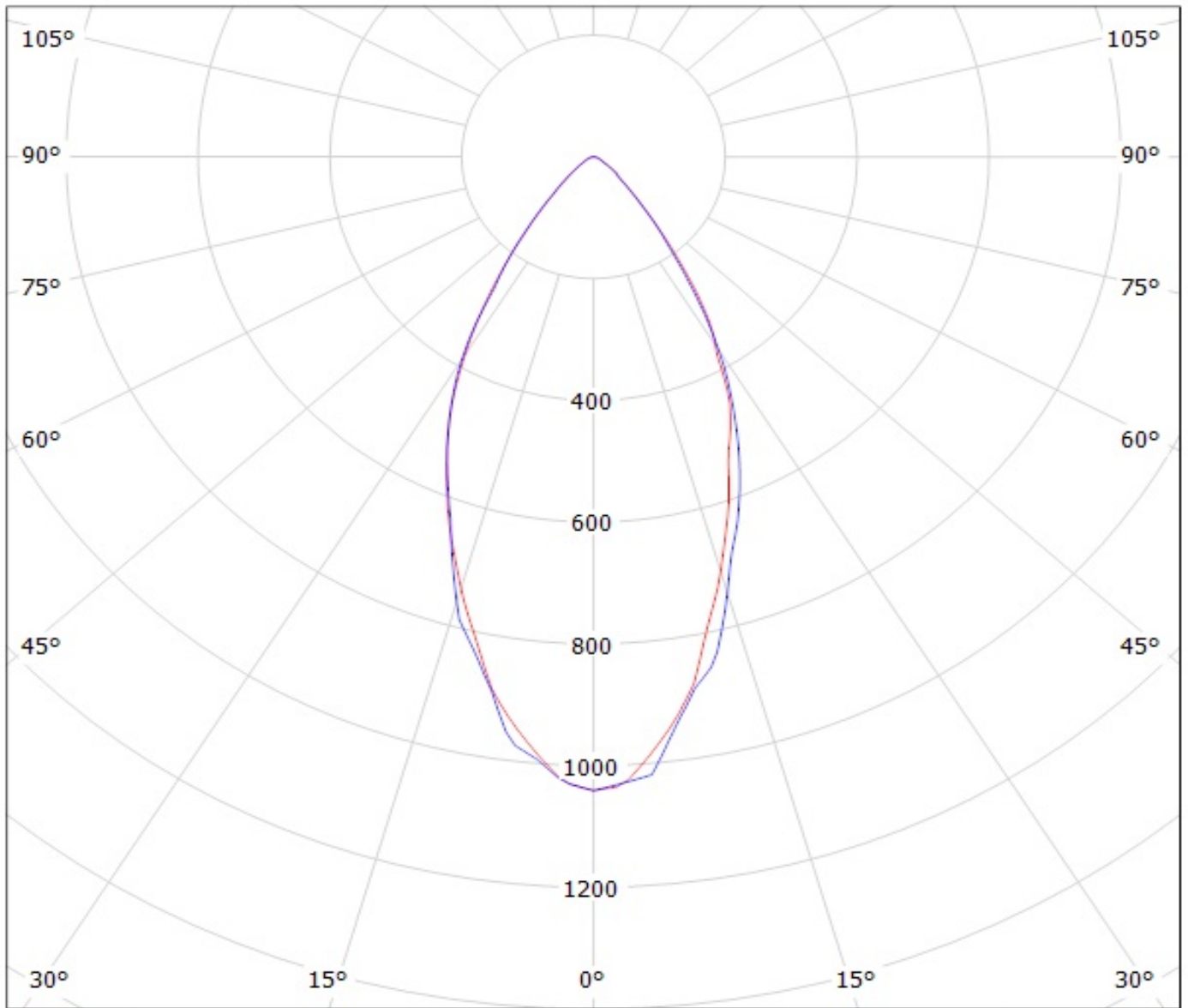

cd/klm

— C0 - C180

— C90 - C270

Luminaire: Ledil Oy CN12488_MIRELLA-50-W-PIN-DL (Cree XP-G 92lm @ 250mA) Efficiency=80%
Lamps: 1 x Cree XP-G 92lm @ 250mA

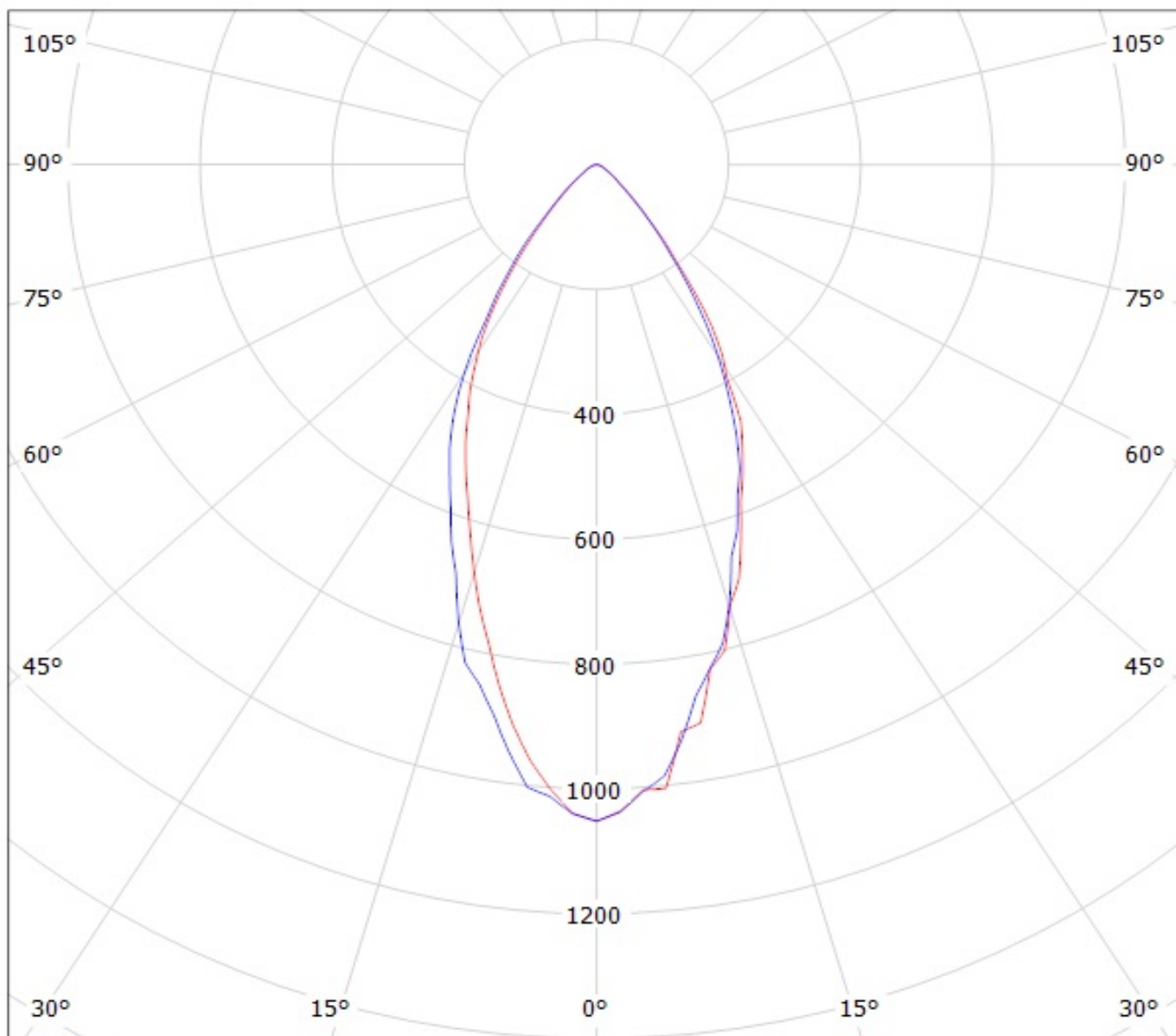

cd/klm

— C0 - C180 — C90 - C270

Luminaire: Ledil Oy CN12488_MIRELLA-50-W-PIN-DL (Cree XT-E 113lm @ 250mA) Efficiency=77%
Lamps: 1 x Cree XT-E 113lm @ 250mA

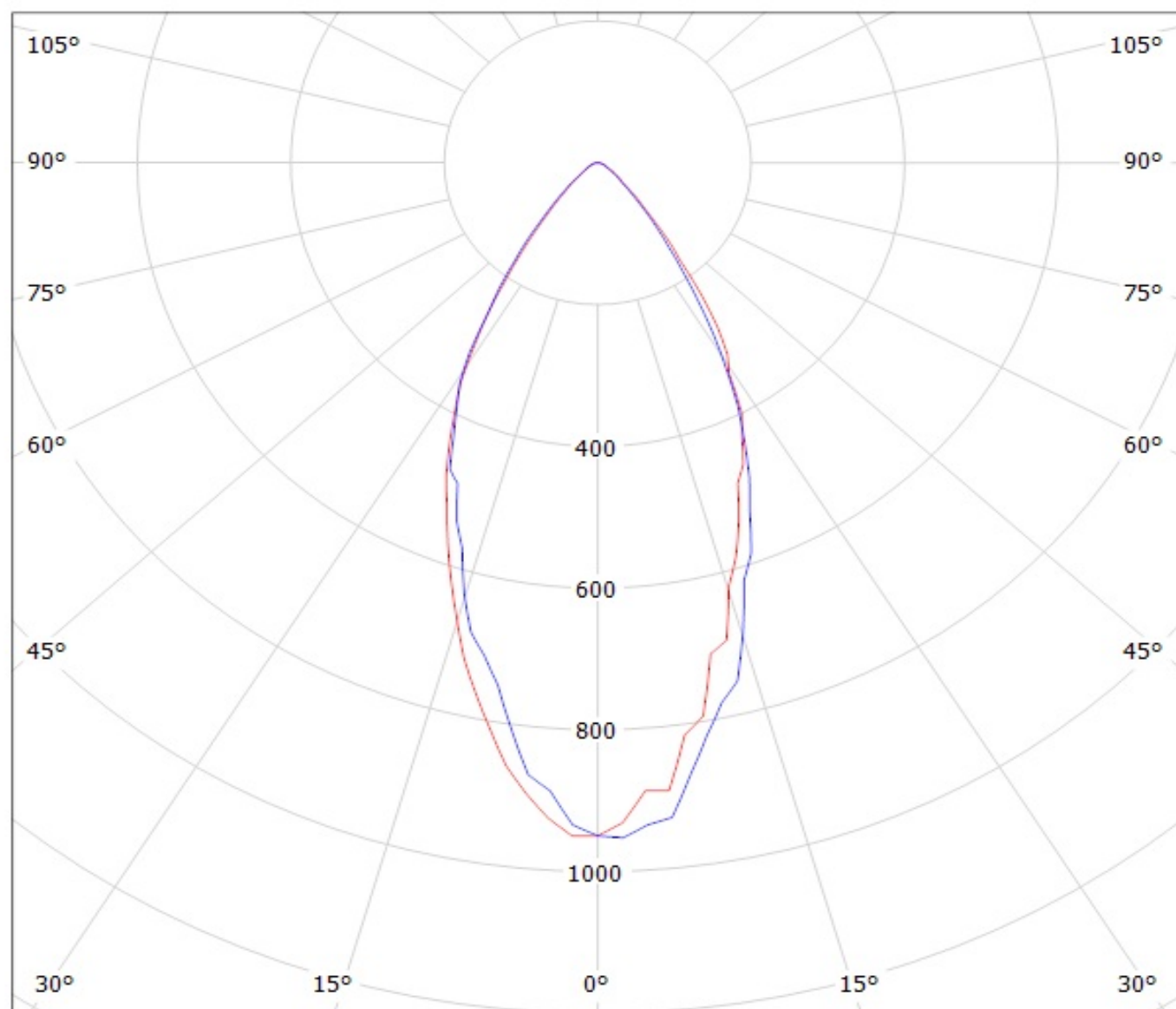

cd/klm

— C0 - C180

— C90 - C270

Luminaire: LEDil Oy CN12488_MIRELLA-50-W-PIN-DL_(XM-L2) Efficiency=81%
Lamps: 1 x Cree XM-L2 (100lm @ 250mA) P=0.7W I=250mA

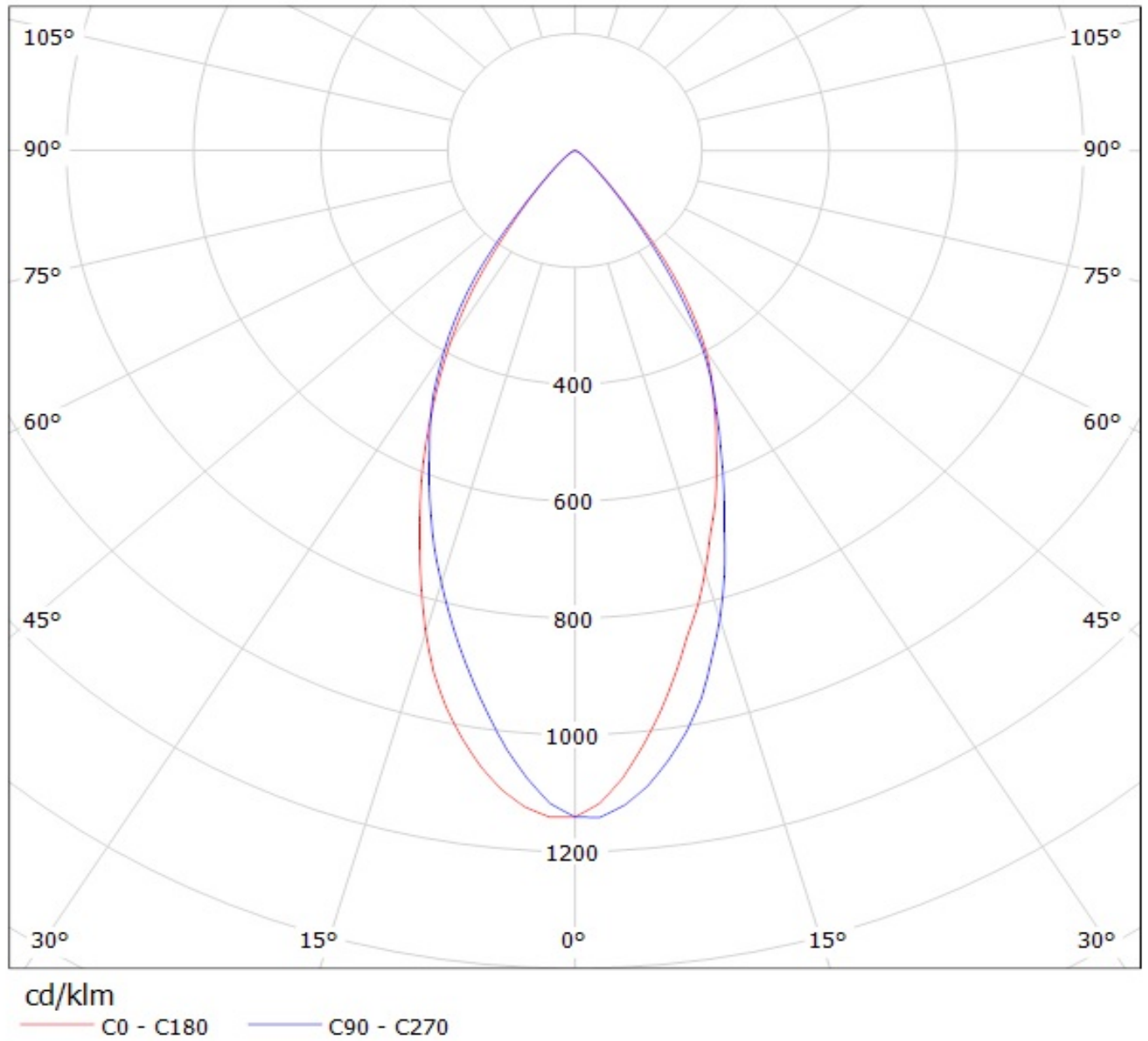

Luminaire: LEDiL Oy CN12488_MIRELLA-50-W-PIN-DL_(CREE_XHP50_WARM_WHITE)
Lamps: 1 x CREE_XHP50_WARM_WHITE_195.491lm@250mA_P=1.39994W_I=0.2499A

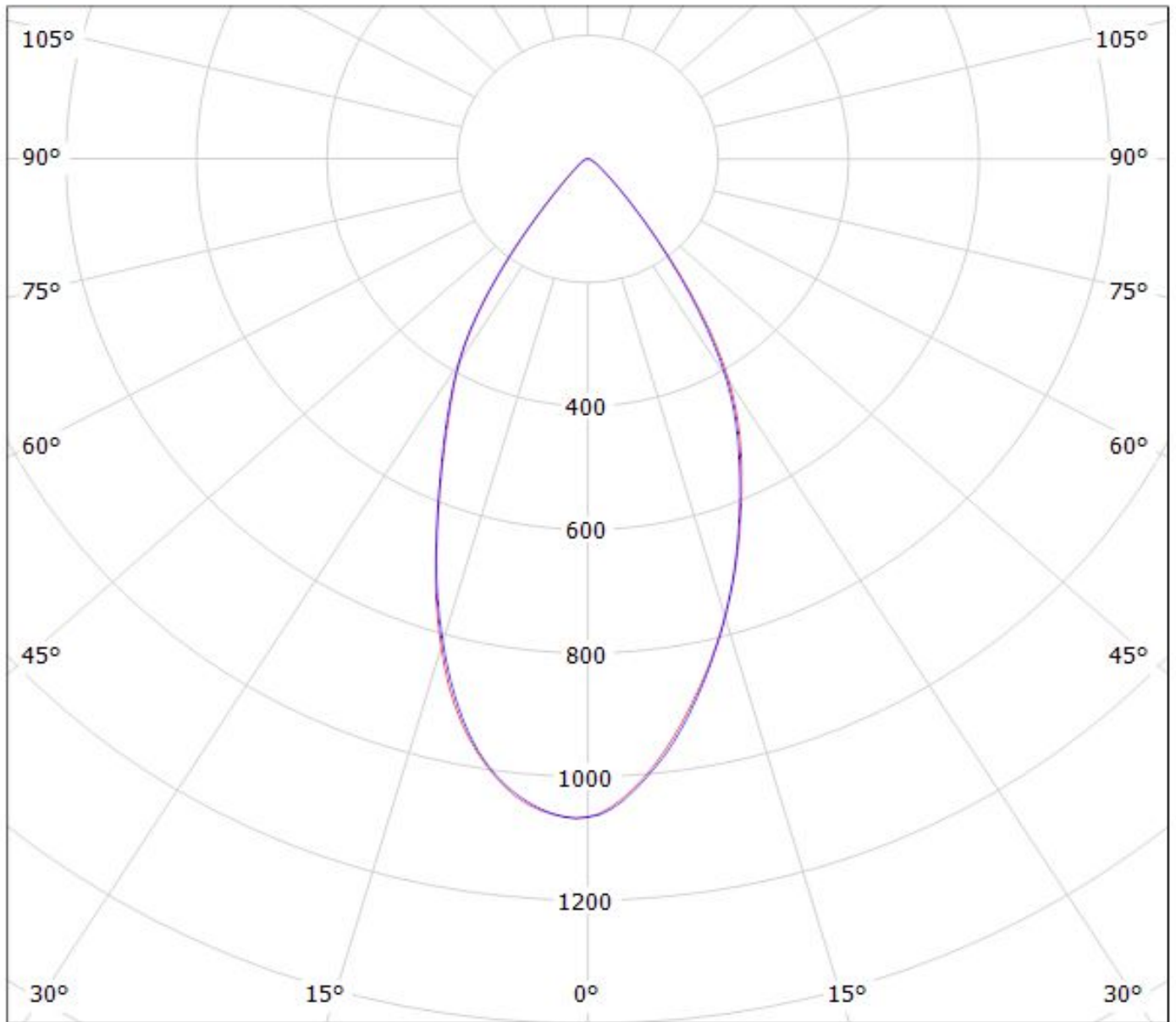

cd/klm

$\eta = 84\%$

— C0 - C180 — C90 - C270

Luminaire: Ledil Oy CN12488_MIRELLA-50-W-PIN-DL (Luxeon A 70lm @ 250mA) Efficiency=80%
Lamps: 1 x Luxeon A 70lm @ 250mA

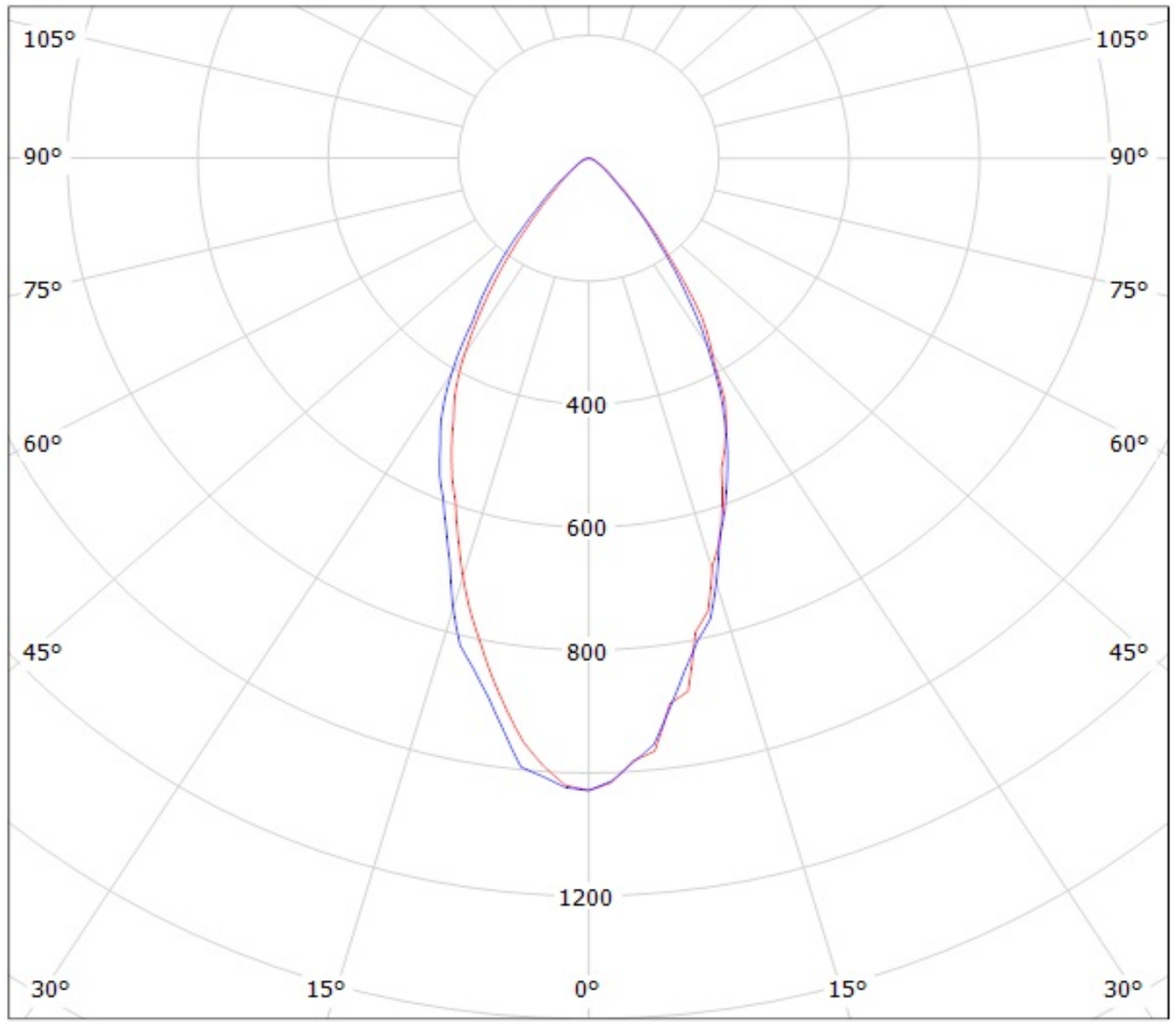

cd/klm

— C0 - C180

— C90 - C270

Luminaire: Ledil Oy CN12488_MIRELLA-50-W-PIN-DL_(Luxeon_M) Efficiency=80%
Lamps: 1 x Philips Lumileds Luxeon M (347lm @ 250mA) CCT=4100K P=2.7W I=250mA

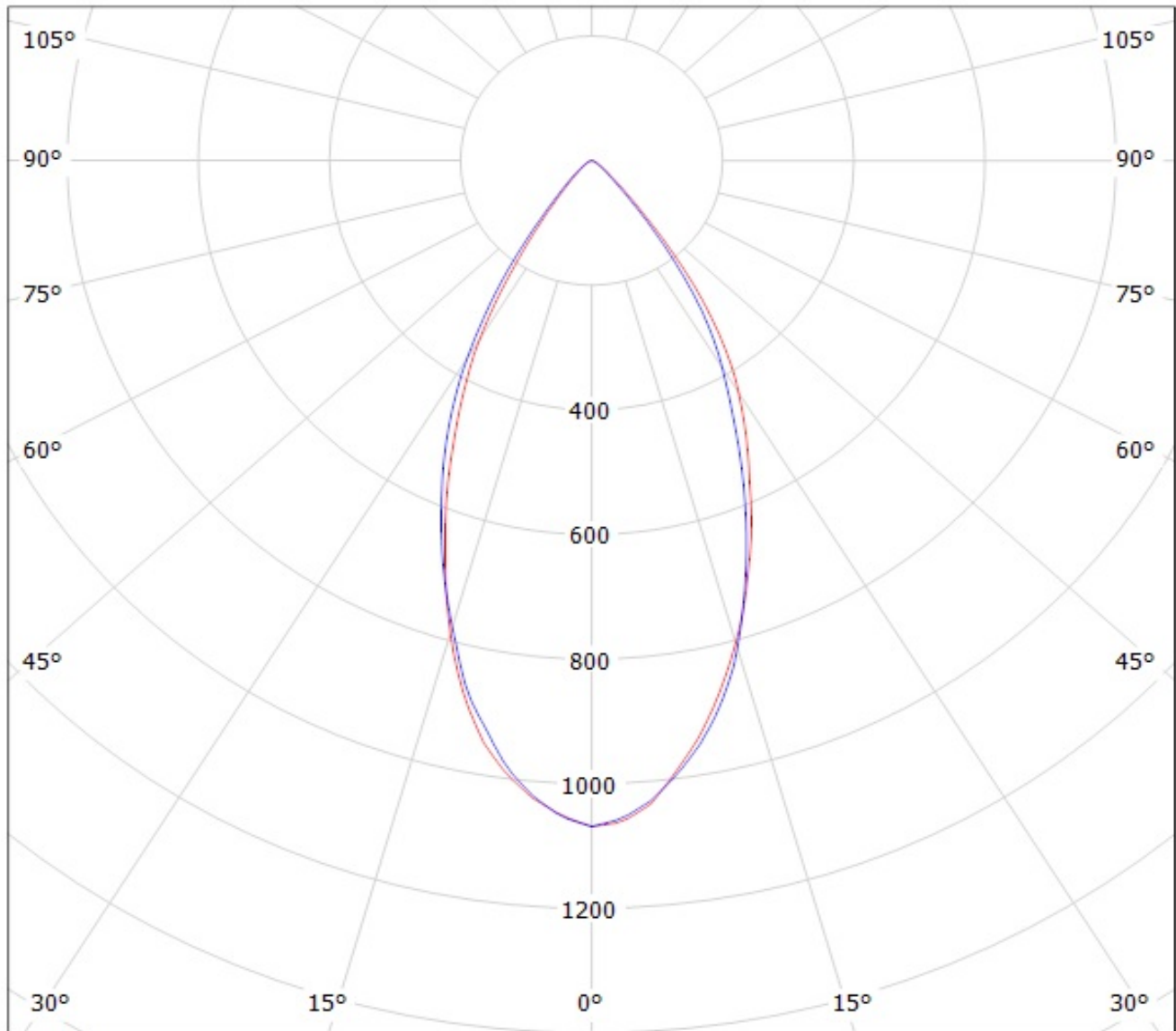

cd/klm

— C0 - C180 — C90 - C270

Luminaire: LEDil Oy CN12488_MIRELLA-50-W-PIN-DL_(Luxeon_MZ) Efficiency=82%
Lamps: 1 x Philips Lumileds Luxeon MZ (389lm @ 250mA) CCT=3800K P=2.8W I=250mA

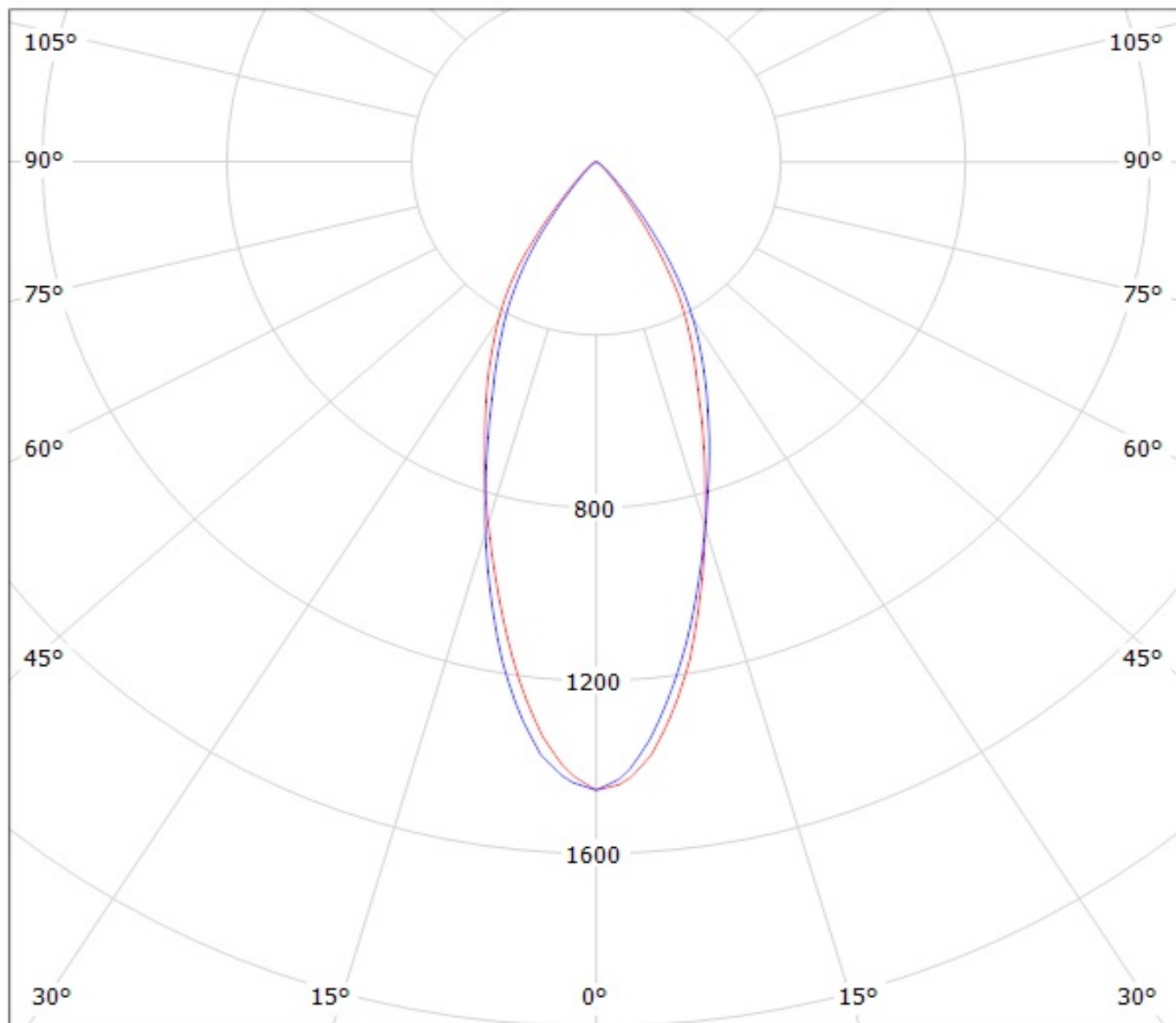

cd/klm

— C0 - C180 — C90 - C270

Luminaire: LEDiL Oy CN12488_MIRELLA-50-W-PIN-DL_(NS9x383) Eff. 82,5%
Lamps: 1 x Nichia NS9x383 (105lm@250mA)

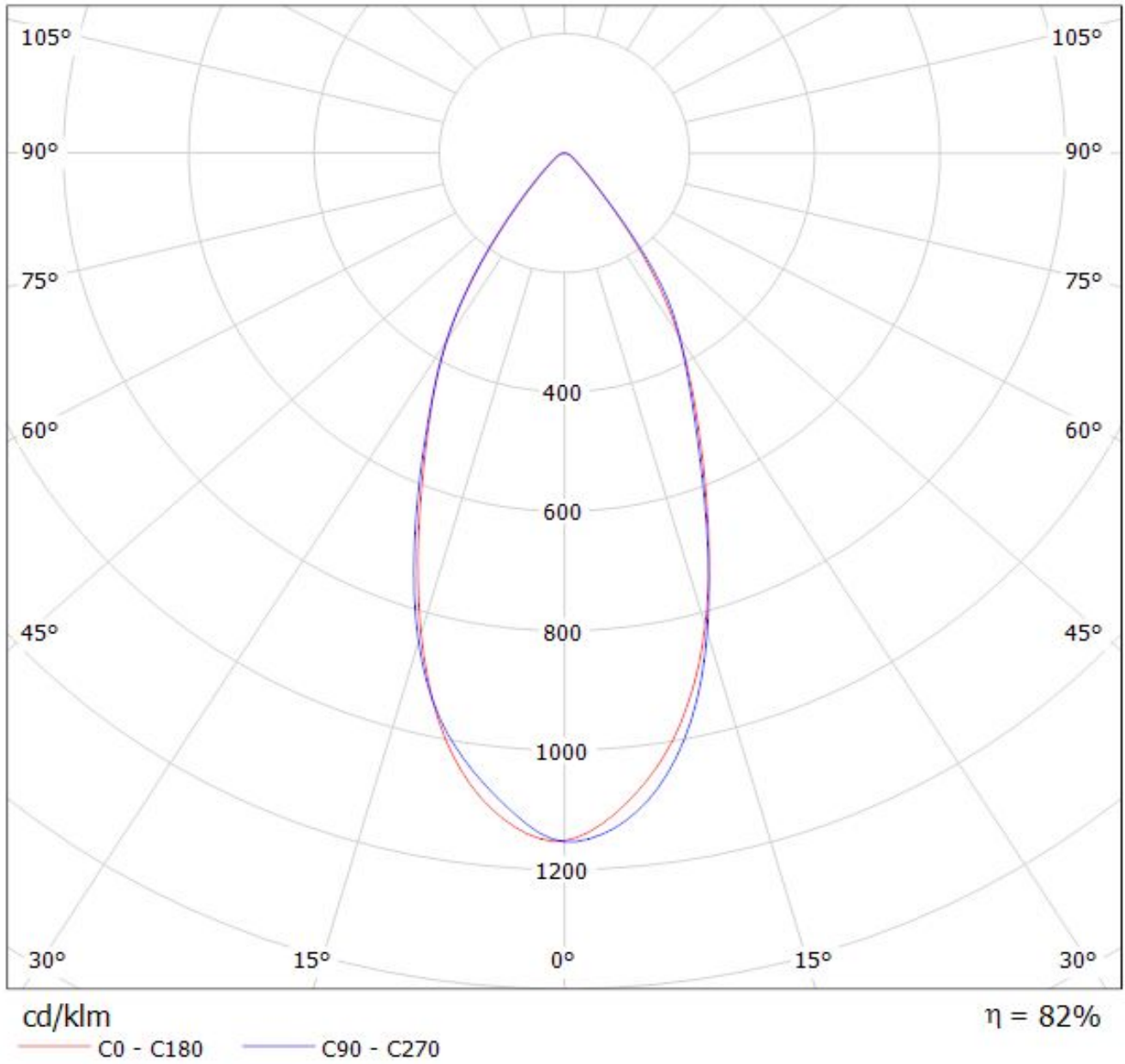

Luminaire: Ledil Oy CN12488_MIRELLA-50-W-PIN-DL (Osram Square EC 78lm @ 250mA) Efficiency=79%
Lamps: 1 x Osram Square EC 78lm @ 250mA

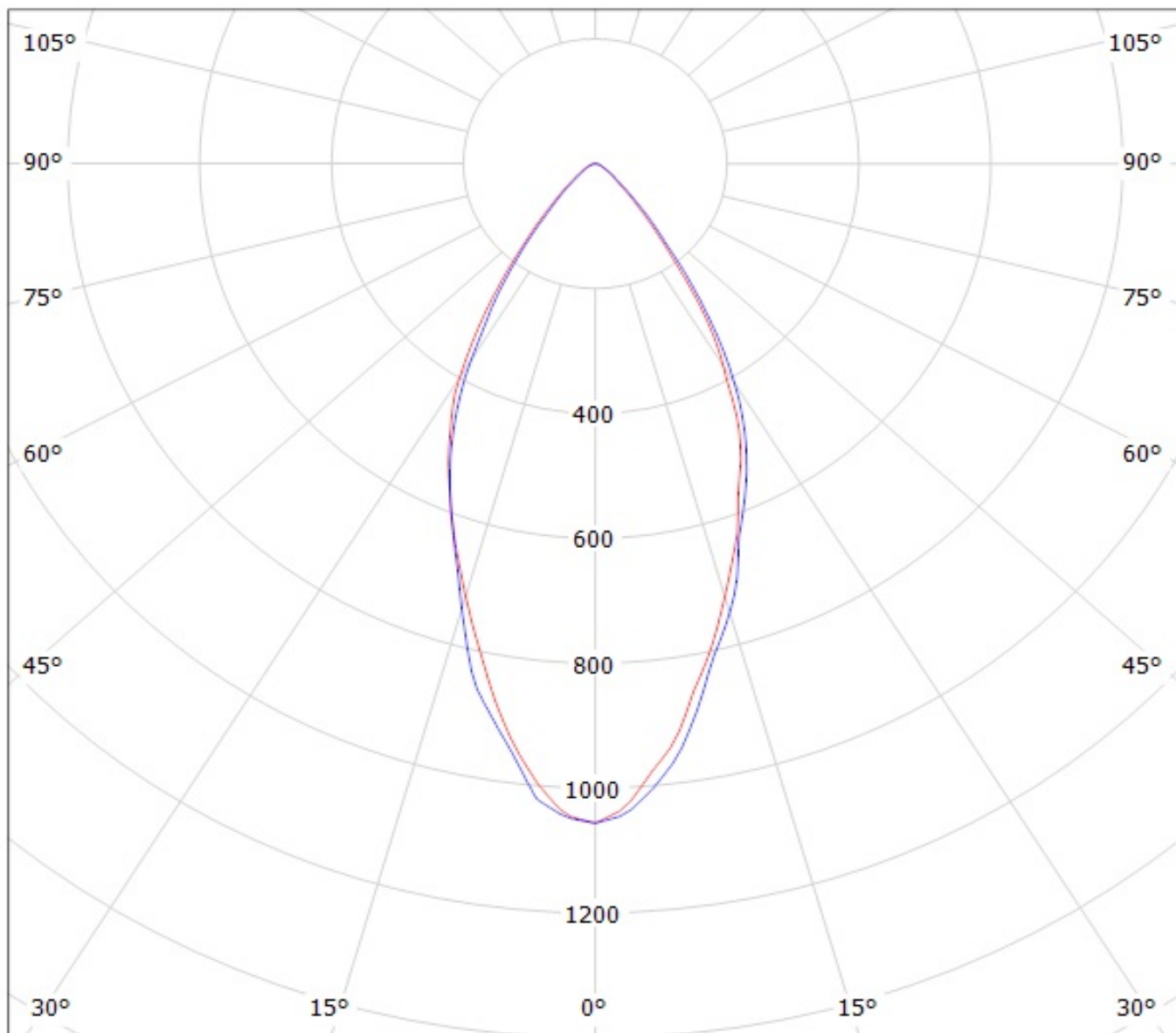

cd/klm

— C0 - C180

— C90 - C270

Luminaire: Ledil Oy CN12488_MIRELLA-50-W-PIN-DL (Osram Duris S8 190lm @ 100mA) Efficiency=83%
Lamps: 1 x Osram Duris S8 190lm @ 100mA (GWP9LMS1.EC) CCT=2857K P=1,8W I=100mA

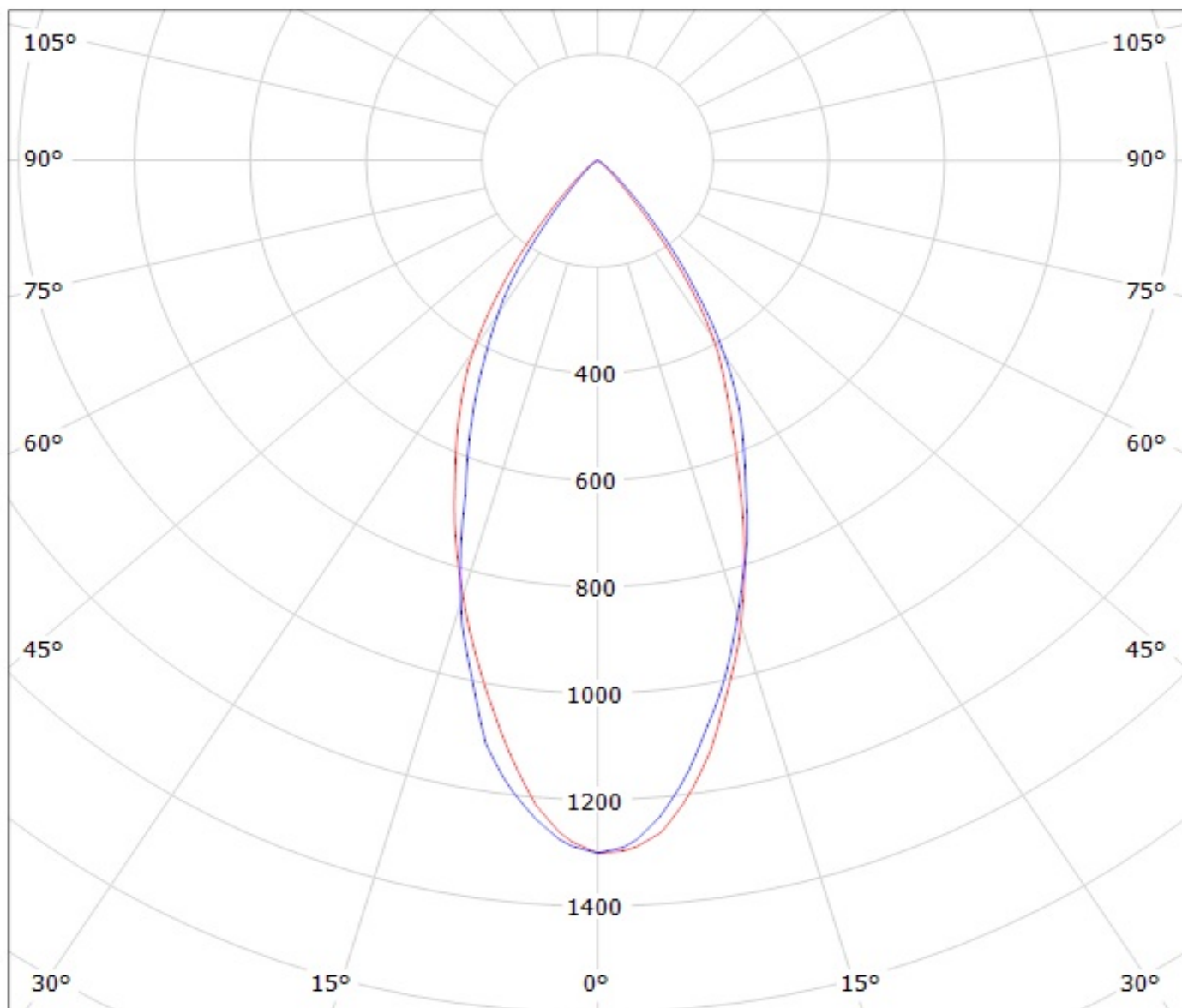

cd/klm

— C0 - C180 — C90 - C270

NOTE: The typical divergence will be changed by different color, chip size and chip position tolerance. The typical total divergence is the full angle measured where the luminous intensity is half of the peak value.