

| REVISIONS |     |                        |           |        |       |
|-----------|-----|------------------------|-----------|--------|-------|
| REV       | ECO | DESCRIPTION            | DATE      | BY     | APPR  |
| A1        | -   | RELEASE NEW DWG FORMAT | NOV/07/15 | SULLEN | TOMMY |

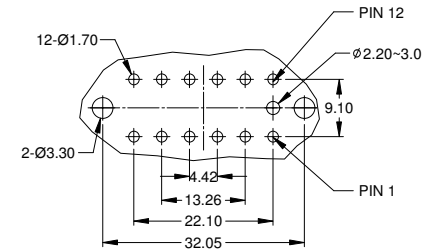

RECOMMENDED LAYOUT  
VIEW FROM COMPONENTS  
SIDE OF PCB

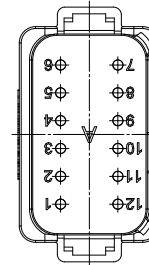
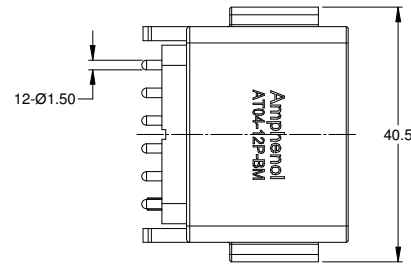
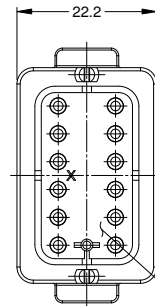
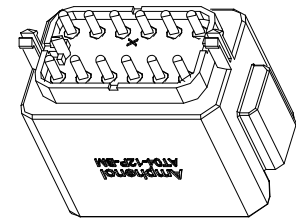
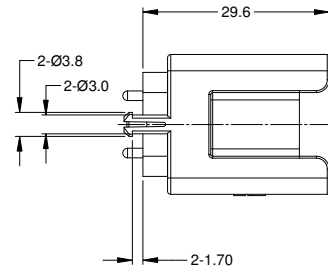
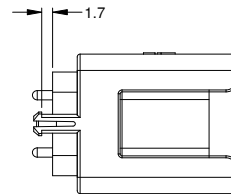

NOTES: UNLESS OTHERWISE SPECIFIED

1. SEE SHEET 2 FOR KEY ARRANGEMENTS AND COLORS.

2. MATERIAL:  
HOUSING: THERMOPLASTIC; COLOR: SEE SHEET 2  
CONTACT: COPPER ALLOY

3. MODIFICATIONS: PCB MOUNT

4. SPECIFICATIONS:  
3.1 CURRENT RATING: 13 AMPS  
3.2 OPERATING TEMPERATURE: -55°C TO +125°C  
3.3 DIELECTRIC WITHSTANDING VOLTAGE: LESS THAN 2 MILLIAMPS CURRENT LEAKAGE @ 1500 VOLTS AC.  
3.4 INSULATION RESISTANCE: 1000 MEGOHMS MIN @ 25°C.  
3.5 MOISTURE RESISTANCE: IP67 ( MATED CONDITION )  
3.6 MATING CYCLE DURABILITY: 100 CYCLES  
3.7 RoHS COMPLIANT

5. MATING PART: AT06-12SX\* PLUG  
( X = A,B,C,D KEYS; \* = MODIFICATIONS AND COLORS )

6. ALL DIMENSIONS ARE FOR REFERENCE USE ONLY.

TITLE: RECEPTACLE, 12 PIN, PCB BOARD MOUNT  
DWG NO.: AT04-12PX-BMXX  
REV: A1  
SH: 1  
OF: 2

| QUANTITY   | PART NUMBER | DESCRIPTION   | ITEM  |
|--|-------------|---|---|
| <b>MATERIALS LIST</b>  |             |   |   |
| UNLESS OTHERWISE SPECIFIED<br>1) All dimensions are in metric (mm).<br>2) Tolerances are as follows:<br>1 PL DEC ±0.30   Fractions ±1/64<br>2 PL DEC ±0.15   Angles ±1°<br>3 PL DEC ±0.08<br>3) Note reference = |             | SIGNATURES<br>DRAWN: SULLEN, ZHANG<br>CHECKED: ORION LI<br>ENGINEER:<br>APPROVAL: TOMMY, XIE<br>CUSTOMER:   | DATE<br>07/NOV/15<br>07/NOV/15<br>07/NOV/15             |
| MATERIAL SPECIFICATIONS:   |             | <b>Amphenol</b><br>Sine Systems - www.amphenol-sine.com<br>44724 Marley Drive<br>Clinton Township, MI 48036 |   |
| PROCESS SPECIFICATIONS:  |             | RECEPTACLE, 12 PIN,<br>PCB, BOARD MOUNT   |   |
| NEXT ASSY:   |             | SIZE: B C-<br>SCALE: NONE   | DWG NO.: AT04-12PX-BMXX<br>REVISION: A1<br>SHEET 1 OF 2 |

| REVISIONS |     |                        |           |        |       |
|-----------|-----|------------------------|-----------|--------|-------|
| REV       | ECO | DESCRIPTION            | DATE      | BY     | APPR  |
| A1        | -   | RELEASE NEW DWG FORMAT | NOV/07/15 | SULLEN | TOMMY |

P/N AT04-12PA-BMXX  
KEY-A CONFIGURATION  
COLOR: GREY

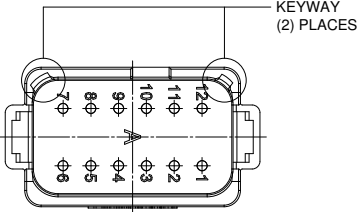
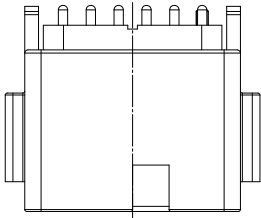

P/N AT04-12PB-BMXX  
KEY-B CONFIGURATION  
COLOR: BLACK

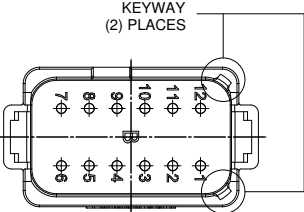
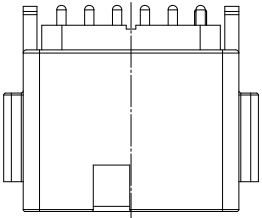

P/N AT04-12PC-BMXX  
KEY-C CONFIGURATION  
COLOR: GREEN

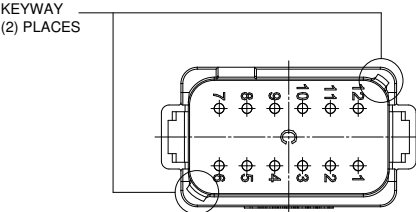
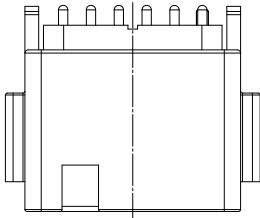

P/N AT04-12PD-BMXX  
KEY-D CONFIGURATION  
COLOR: BROWN

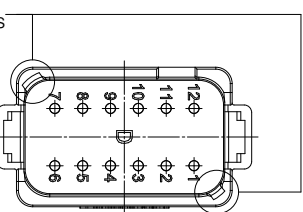
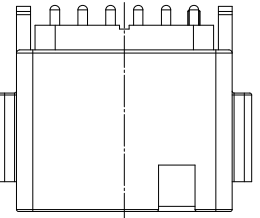

| AT04-12PA-BMXX VARIANTS |                             |                |
|-------------------------|-----------------------------|----------------|
| CONTACT PLATING         | POTTING OR NOT IN RESERVOIR | PART NUMBER    |
| GOLD                    | NO POTTING                  | AT04-12PA-BM01 |
| GOLD                    | POTTING                     | AT04-12PA-BM02 |
| NICKEL                  | NO POTTING                  | AT04-12PA-BM03 |
| NICKEL                  | POTTING                     | AT04-12PA-BM04 |

| AT04-12PB-BMXX VARIANTS |                             |                |
|-------------------------|-----------------------------|----------------|
| CONTACT PLATING         | POTTING OR NOT IN RESERVOIR | PART NUMBER    |
| GOLD                    | NO POTTING                  | AT04-12PB-BM01 |
| GOLD                    | POTTING                     | AT04-12PB-BM02 |
| NICKEL                  | NO POTTING                  | AT04-12PB-BM03 |
| NICKEL                  | POTTING                     | AT04-12PB-BM04 |

| AT04-12PC-BMXX VARIANTS |                             |                |
|-------------------------|-----------------------------|----------------|
| CONTACT PLATING         | POTTING OR NOT IN RESERVOIR | PART NUMBER    |
| GOLD                    | NO POTTING                  | AT04-12PC-BM01 |
| GOLD                    | POTTING                     | AT04-12PC-BM02 |
| NICKEL                  | NO POTTING                  | AT04-12PC-BM03 |
| NICKEL                  | POTTING                     | AT04-12PC-BM04 |

| AT04-12PD-BMXX VARIANTS |                             |                |
|-------------------------|-----------------------------|----------------|
| CONTACT PLATING         | POTTING OR NOT IN RESERVOIR | PART NUMBER    |
| GOLD                    | NO POTTING                  | AT04-12PD-BM01 |
| GOLD                    | POTTING                     | AT04-12PD-BM02 |
| NICKEL                  | NO POTTING                  | AT04-12PD-BM03 |
| NICKEL                  | POTTING                     | AT04-12PD-BM04 |

| SEE PART NUMBER CHART  |             | DESCRIPTION  | ITEM   |
|--|-------------|--|--|
| QUANTITY   | PART NUMBER |  |  |
| <b>MATERIALS LIST</b>  |             |  |  |
| <small>UNLESS OTHERWISE SPECIFIED</small><br>1) All dimensions are in metric (mm).<br>2) Tolerances are as follows:<br>1 PL DEC ±0.30   Fractions ±1/64<br>2 PL DEC ±0.15   Angles ±1°<br>3 PL DEC ±0.08<br>3) Note reference - $\Delta$ |             | SIGNATURES    DATE<br>DRAWN: SULLEN ZHANG    07/NOV/15<br>CHECKED: ORION LI    07/NOV/15<br>ENGINEER:<br>APPROVAL: TOMMY XIE    07/NOV/15<br>CUSTOMER:   | <br>Sine Systems - www.amphenol-sine.com<br>44724 Morley Drive<br>Clinton Township, MI 48036 |
| MATERIAL SPECIFICATIONS:<br><br>PROCESS SPECIFICATIONS:<br><br>NEXT ASSY:  |             | THIS DRAWING IS SUPPLIED FOR INFORMATION ONLY. DESIGN FEATURES, SPECIFICATIONS AND PERFORMANCE DATA SHOWN HEREON ARE THE PROPERTY OF THE AMPHENOL CORPORATION. NO RIGHTS OF REPRODUCTION ARE IMPLIED. ALL DIMENSIONS ARE SUBJECT TO NORMAL MANUFACTURING VARIATIONS. |  |
| SIZE: <b>B C-</b><br>SCALE: NONE   |             | DWG NO: <b>AT04-12PX-BMXX</b>  | REVISION: <b>A1</b><br>SHEET 2 OF 2  |

TITLE: RECEPTACLE, 12 PIN, PCB BOARD MOUNT    DWG NO: AT04-12PX-BMXX    REV: A1    SH: 2    OF: 2